

PENSAFETM INC.

S T R E N G T H & S E C U R I T Y



DESIGNED TO CLOSE OVER A 4" DIAMETER

CATALOGUE 2025

25-08

New!



Page 47

9242



Page 10



Page 48

9245



Page 6

9697



Page 48

9254



Page 19

C335-35

New!



Page 20

A353PS



Page 20

A357PS



Page 22

A853PS



Page 22

A857PS



Page 23

A953PS



Page 23

A957PS



Page 24

A973PS



Page 24

A977PS



Page 24

A1187

ORDERING INFORMATION

In order to ensure that your orders are processed without delay, we recommend that all purchase orders include the following information:

- P.O. Number
- PENSAFE Part Number
- Customer Part Number
- Quantity required
- Unit Cost
- Sold to Address
- Ship to Address
- Required Delivery Date
- Method of Transportation - Ground, Air or Ocean
- Carrier/Courier and corresponding Account Number
- IRS Number (United States only)

Please request box quantity for optimal ordering.

All goods are supplied subject to our standard conditions of sales which are available upon request and are supplied with each order acknowledgement.



Visa Payments are accepted.

Note - PenSafe reserves the right to adjust pricing at any time.

CONTACT INFORMATION

PENSAFE Inc. and Customer Service personnel are available to assist you with any of your sales or technical questions between the hours of 8:00am to 4:30pm Eastern Standard Time, Monday through Friday.

Mailing Address:	PENSAFE INC. 1175 Barton St. Unit #4 Stoney Creek, Ontario Canada L8E 5H1	Telephone: Toll Free(North America): Sales: Fax: Email: Website:	905-643-7188 866-212-2211 1-780-666-0103 905-643-5088 Sales@pensafe.ca http://www.pensafe.ca
------------------	---	---	---

RETURN POLICY

All returns require prior authorization from PENSAFE Inc. Please contact your Customer Service Representative to discuss the nature of the return and to obtain an RMA Number for tracking and processing.

Reference to the RMA Number should be noted on all documents accompanying the equipment returned in order to properly identify and process as soon as possible.

All returns that are not resultant from manufacturing defects are subject to a 30% restocking charge and are subject to final inspection and approval upon receipt.

Additional charges may apply based on the condition of the equipment returned.

Appropriate credits will be issued upon verification of counts, inspection and final approval of the equipment received.

COMMITMENT TO QUALITY

Our commitment to quality is not only a function of our Product Integrity Department but a commitment of every employee. Our ISO 9001 certified operating system has not only streamlined all facets of our business but has also given us a focus towards a formalized continuous improvement program. This continuous improvement program enables us to fine tune our products and processes which in turn benefit our Customers.

All of our products are rigorously tested during the design stage to ensure conformance to current revision of the appropriate National and International Standards (i.e. CSA Z-259.12-, ANSI/ASSE Z-359.19-, NFPA 2500 (1983), 2022 ED, EN 362;) even before production begins. Our facilities in Canada and Asia are CSA certified.

Testing of product during production begins at the raw material stage and continues throughout processing. All test data is traceable to the end product and continuously monitored to ensure an optimum finished part.

Methods of test include:

- Magnetic Particle Inspection
- Liquid Penetrant Inspection
- Dimensional Verification
- Hardness Testing
- Tensile Testing
- Visual Analysis
- Functional Analysis (if applicable)

All product shipments include a "Certificate of Test" for each part number included in the shipment. This "Certificate of Test" formally outlines the specifications that the part meets or exceeds and is our written Guarantee of Product Integrity.



<div style="display: flex; justify-content: space-between;"> <div> PENSAFE™ INC. STRENGTH & SECURITY </div> <div> Pensafe Inc. Unit 4, 1175 Barton Street Stoney Creek, Ontario, Canada L8E 5H1 Phone (Toll Free): 1-866-212-2211 Phone: 905-643-7188 Fax: 905-643-5088 Website: www.pensafe.ca </div> </div>	
<div style="border: 1px solid black; padding: 2px; display: inline-block;">Certificate of Test</div>	
<div style="display: flex; justify-content: space-between;"> <div>Packing Slip: 0</div> <div>Ship Date:</div> </div>	
Part Number:	5944-25-0-00-11-3
Customer Part Number:	
Part Description:	hook form 4" aluminum black anodized
Heat Code:	24 A
Material:	ALUMINUM
Specification:	Certified to ANSI Z359.12-2019 & CSA Z259.12-16
Minimum Tensile Load (lbs):	22.5kN(5000lbs)
Minimum Gate Load (lbs)	16kN(3600lbs)
Minimum Side Load (lbs):	16kN(3600lbs)
Hardness:	T6 condition
Corrosion Resistance:	ANODIZED
Remarks:	100% Proof Loaded to 16kN (3600 LBS)
Note:	Chemical Analysis available upon request.
<p>The customer, including but not limited to Product Distributors and OEM manufacturers, agree and acknowledge that it is solely responsible for conveying to its customers and/or end users, warnings and information concerning the use of the Product including but not limited to: the dangers associated with part usage compatibility, improper connection, accidental barrel disengagement, accidental disengagement, gate face loading, accidental lock-lever deactivation, connector tip loading, deliberate lock lever deactivation, multiple loading and cleaning and usage. The customer shall hold Pensafe harmless from and indemnify Pensafe against any and all claims, demands and actions based upon or arising out of any activities performed by Pensafe and its employees and agents pursuant to this shipment and shall, at the request of Pensafe, defend any and all actions brought against Pensafe based upon any such claims or demands.</p> <p>We hereby certify that the results in the attached documents are correct to the best of our knowledge as contained in the company records.</p> <div style="text-align: center;">  Terry Stangeo Product Integrity Dept PENSAFE™ INC. STRENGTH & SECURITY </div>	

MARKINGS ON SAFETY COMPONENTS

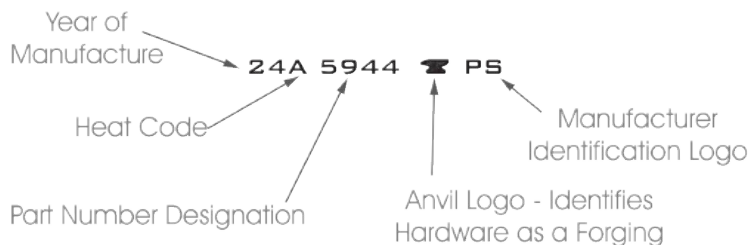

Salt Spray Application

Our standard finishes exceed the minimum Salt Spray resistance as required by the the current revision of the applicable national and international standards. Specific finish corrosion resistance is available upon request.

Standard Finishes



Clear Chromate
Finish - 11
(Standard)

Yellow Dichromate
with Leach Back
and Sealant
Finish - 12
(Optional)

E-Coat
Finish - 35
(Optional)

Anodized Colors



Clear
Finish - 21
(Optional)

Black
Finish - 25
(Standard)

Red
Finish - 23
(Optional)

Minimum order quantities apply for optional finishes, please contact Customer Service for details and availability.

TABLE OF CONTENTS

SELF LOCKING SNAP HOOKS 5

SELF LOCKING FORM SNAP HOOKS..... 9

CARABINERS..... 12

LIFTING CARABINERS/QUICK RIGGING CONNECTORS.25

ANCHORAGE CONNECTORS 26

FALL ARRESTERS..... 29

RINGS 31

BUCKLES..... 41

DIELECTRIC INFO PAGE..... 51

PARACHUTE\RESCUE..... 52

MISCELLANEOUS..... 55

STANDARDS COMPARISON 61

WARNINGS CONNECTING COMPONENTS 62

PART NUMBER REFERENCE 66

SELF LOCKING SNAP HOOKS

Certified to ANSI Z359.12-2019 and CSA Z259.12-16

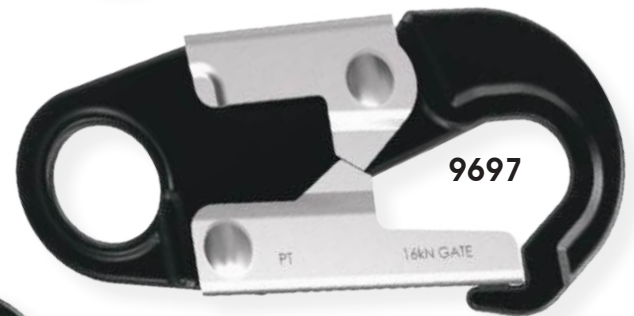

(1) Slotted Tip



(2) Interlocking Tip



SELF LOCKING SNAP HOOKS

6692

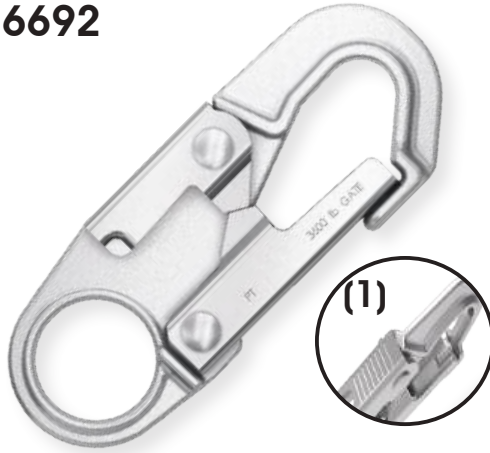

Specifications

- 6692 3/4" Snap Hook
- Drop Forged Steel
- 100% proof loaded to 3,600 lbs (16 kN)
- Min tensile strength 5,000 lbs (22.2 kN)
- Min gate strength 3,600 lbs (16 kN)
- Min side load strength 3,600 lbs (16 kN)

Certified to:

- ANSI/ASSP Z359.12-2019
- CSA Z259.12-16

Meets or Exceeds:

- EN362-2004

Weight: 12.27oz (347.9gm)

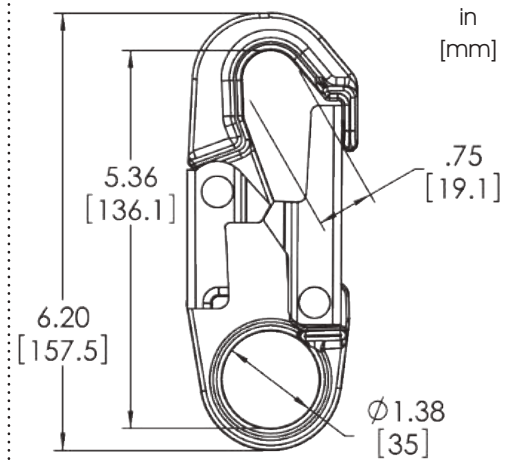

9692



Specifications

- 9692 3/4" Snap Hook
- Sheet Stamping Steel
- 100% proof loaded to 3,600 lbs (16kN)
- Min tensile strength 5,000 lbs (22.2kN)
- Min gate strength 3,600 lbs (16kN)
- Min side load strength 3,600 lbs (16kN)

Certified To:

- ANSI/ASSP Z359.12-2019
- CSA Z259.12-16

Meets Or Exceeds:

- EN362-2004

Weight: 10.9oz (310gm)

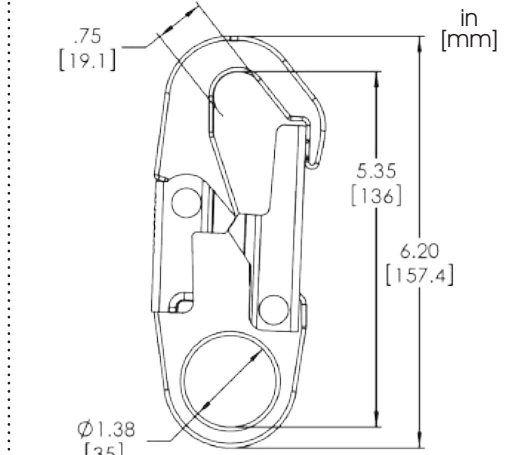

9695



Specifications

- 9695 3/4" Snap Hook
- Drop Forged Aluminum
- 100% proof loaded to 3,600 lbs (16 kN)
- Min tensile strength 5,000 lbs (22.2 kN)
- Min gate strength 3,600 lbs (16 kN)
- Min side load strength 3,600 lbs (16 kN)

Certified to:

- ANSI/ASSP Z359.12-2019
- CSA Z259.12-16

EN362-2004

Weight: 7.93oz (225gm)

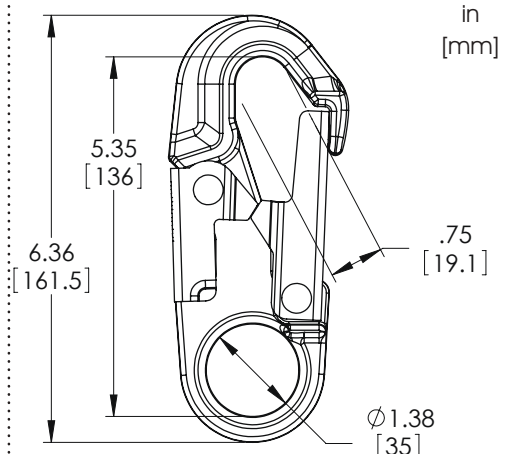

9697



Specifications

- 9697 3/4" Snap Hook
- Drop Forged Aluminum
- 100% proof loaded to 3,600 lbs (16 kN)
- Min tensile strength 5,000 lbs (22.2 kN)
- Min gate strength 3,600 lbs (16 kN)
- Min side load strength 3,600 lbs (16 kN)

Certified to:

- ANSI/ASSP Z359.12-2019
- CSA Z259.12-16

Weight: 7.93oz (225gm)

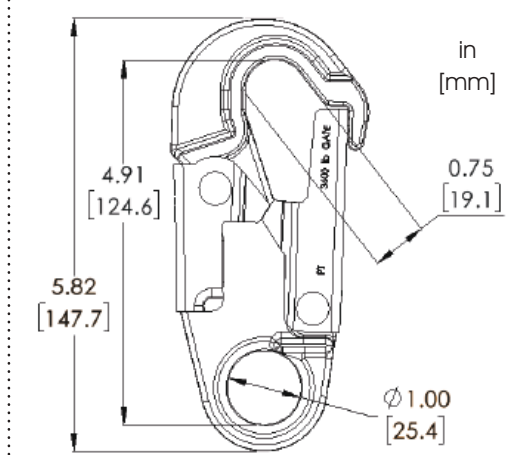

SELF LOCKING SNAP HOOKS

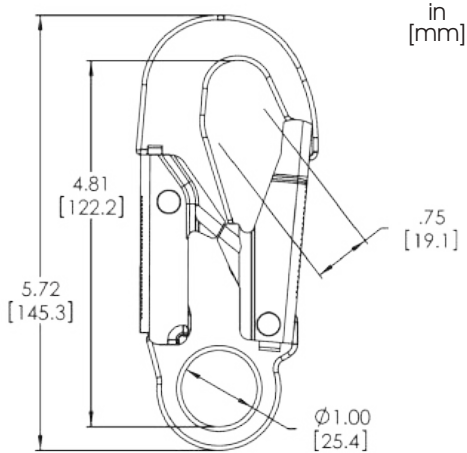

Specifications

- 9652 3/4" Snap Hook
- Sheet Stamping Steel
- 100% proof loaded to 3,600 lbs (16kN)
- Min tensile strength 5,000 lbs (22.2kN)

Certified To:

- EN362-2004

Weight: 10oz (281gm)

9652

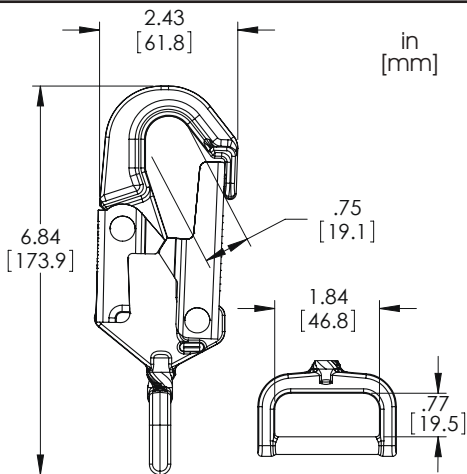

Specifications

- 5692 3/4" Strap Snap Hook
- Drop Forged Steel
- 100% proof loaded to 3,600 lbs (16kN)
- Min tensile strength 5,000 lbs (22.2kN)

Certified To:

- ANSI/ASSP Z359.12-2019
- CSA Z259.12-16

Meets Or Exceeds:

- EN362-2004

Weight: 14.0oz (398gm)

5692

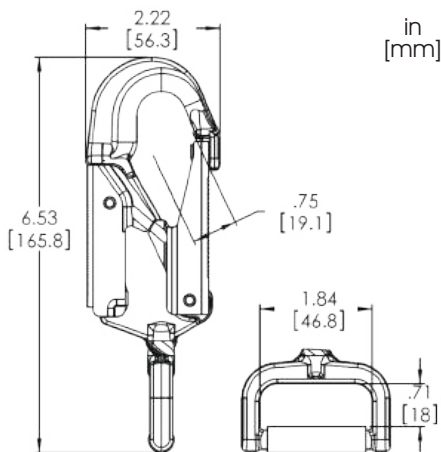

Specifications

- 6600 3/4" Strap Snap Hook
- Drop Forged Steel
- 100% proof loaded to 3,600 lbs (16kN)
- Min tensile strength 5,000 lbs (22.2kN)

Certified To:

- EN362-2004

Weight: 12.9oz (364gm)

6600

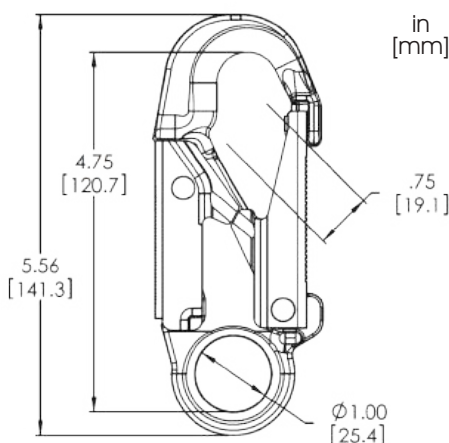

Specifications

- 6650 3/4" Snap Hook
- Drop Forged Steel
- 100% proof loaded to 3,600 lbs (16kN)
- Min tensile strength 5,000 lbs (22.2kN)

Meets Or Exceeds:

- EN362-2004

Weight: 10.49oz (292gm)

6650



SELF LOCKING SNAP HOOKS

INDICATOR TECHNOLOGY



Pre-Activation



Indicator activation at 750 lbs
(plus or minus 75 lbs.)

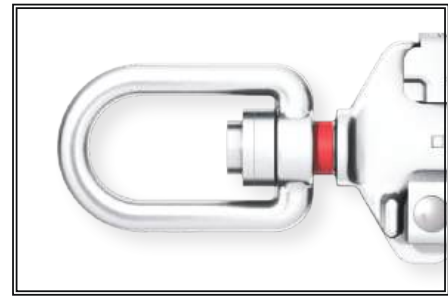

Post-Activation

4692

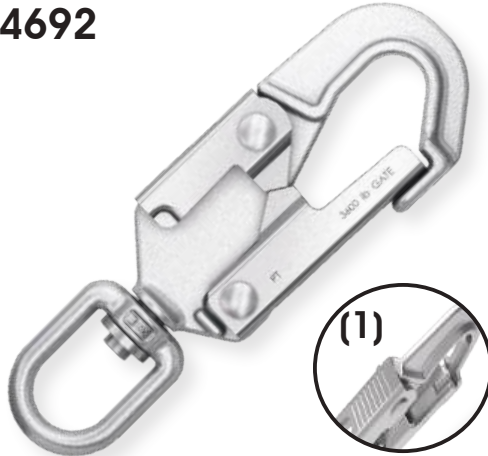

Specifications

- 4692 3/4" Swivel Snap Hook
- Drop Forged Steel
- 100% proof loaded to 3,600 lbs (16 kN)
- Min tensile strength 5,000 lbs (22.2 kN)
- Min gate strength 3,600 lbs (16 kN)
- Min side load strength 3,600 lbs (16 kN)

Certified to:

- ANSI/ASSP Z359.12-2019
- CSA Z259.12-16
- EN362-2004

Weight: 13.85oz (392.8gm)

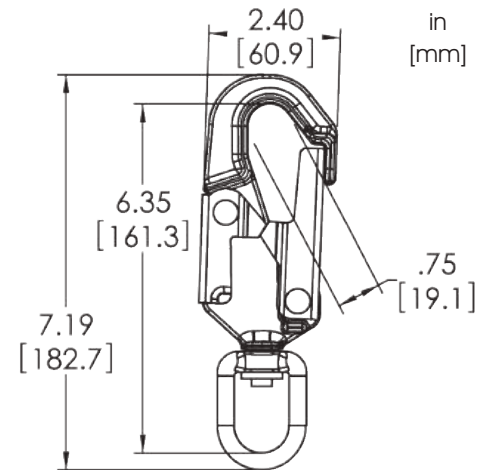

4693



Specifications

- 4693 3/4" Indicator Swivel Snap Hook
- Drop Forged Steel
- 100% proof loaded to 3,600 lbs (16 kN)
- Min tensile strength 5,000 lbs (22.2 kN)
- Min gate strength 3,600 lbs (16 kN)
- Min side load strength 3,600 lbs (16 kN)

Certified to:

- ANSI/ASSP Z359.12-2019
- CSA Z259.12-16
- EN362-2004

Weight: 14.59oz (413.7gm)

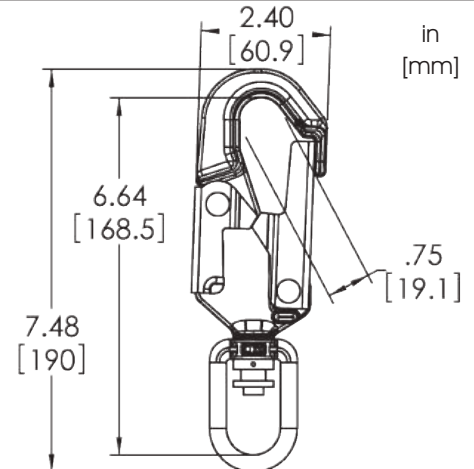

4650



Specifications

- 4650 3/4" Swivel Snap Hook
- Drop Forged Steel
- 100% proof loaded to 3,600 lbs (16 kN)
- Min tensile strength 5,000 lbs (22.2 kN)

Certified To:

- EN362-2004

Weight: 12.5oz (352gm)

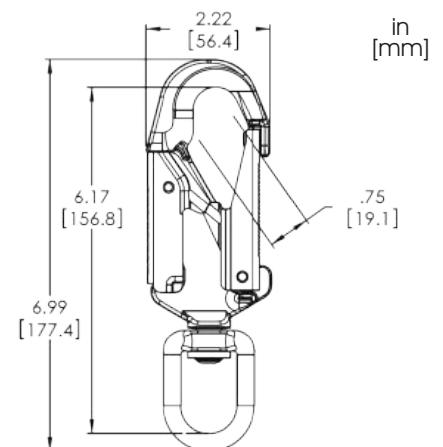

SELF LOCKING FORM SNAP HOOKS

5990 FORGED ALUMINUM FORM HOOK MARKINGS



5870



5944



5990

SELF LOCKING FORM SNAP HOOKS

5870



Specifications

- 5870 2-1/2" Form Snap Hook
- Drop Forged Steel
- 100% proof loaded to 3,600 lbs (16 kN)
- Min tensile strength 5,000 lbs (22.2 kN)
- Min gate strength 3,600 lbs (16 kN)
- Min side load strength 3,600 lbs (16 kN)

Certified to:

- ANSI/ASSP Z359.12-2019
- CSA Z259.12-16

Meets or Exceeds:

- EN362-2004

Weight: 27.87oz (790.2gm)

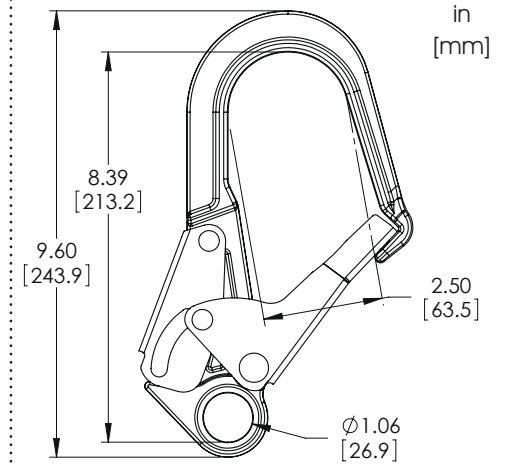

5944



Specifications

- 5944 4" Form Snap Hook
- Drop Forged Aluminum
- 100% proof loaded to 3,600 lbs (16 kN)
- Min tensile strength 5,000 lbs (22.2 kN)
- Min side load strength 3,600 lbs (16 kN)

Certified to:

- ANSI/ASSP Z359.12-2019
- CSA Z259.12-16
- Weight: 45.4oz (1287gm)

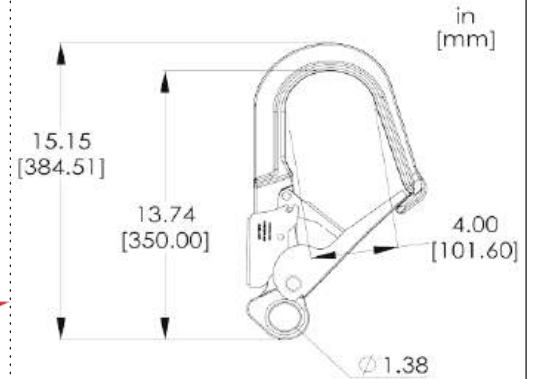

Warnings



SELF LOCKING FORM SNAP HOOKS

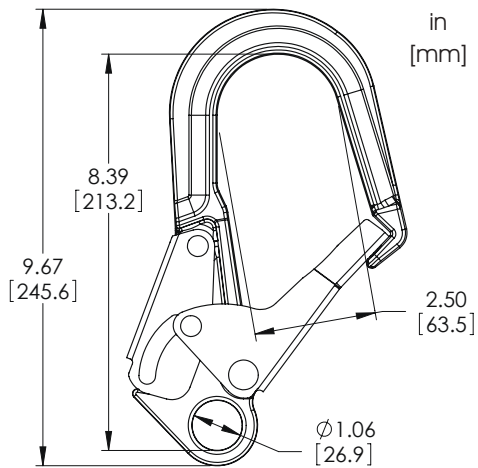

Specifications

- 5990 2-1/2" Form Snap Hook
- Drop Forged Aluminum
- 100% proof loaded to 3,600 lbs (16 kN)
- Min tensile strength 5,000 lbs (22.2 kN)
- Min side load strength 3,600 lbs (16 kN)

Certified to:

- ANSI/ASSP Z359.12-2019
- CSA Z259.12-16
- EN362-2004

Weight: 20.39oz (578.1gm)

5990



DESIGN

DEVELOP

BRAND &
COLOUR

YOUR

ALUMINUM



CARABINER



New!

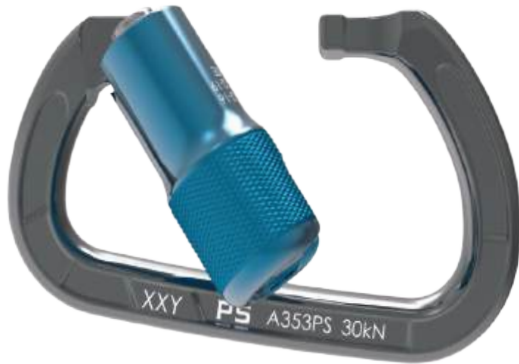

A353PS



A857PS



A953PS



A977PS

OFFSET CARABINERS

OFFSET VS NON-OFFSET CARABINER OPENING

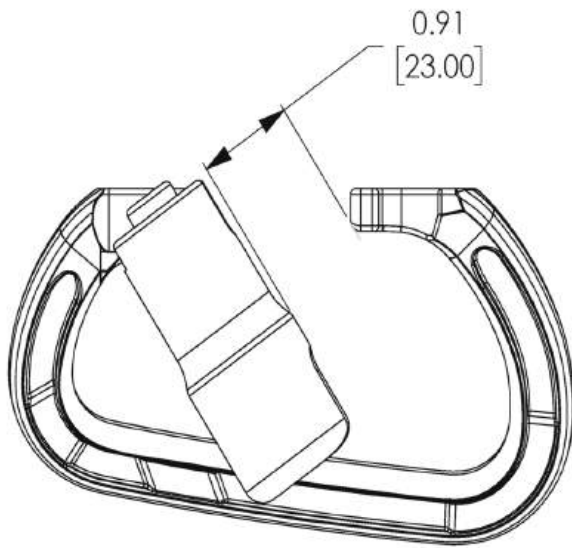

Offset

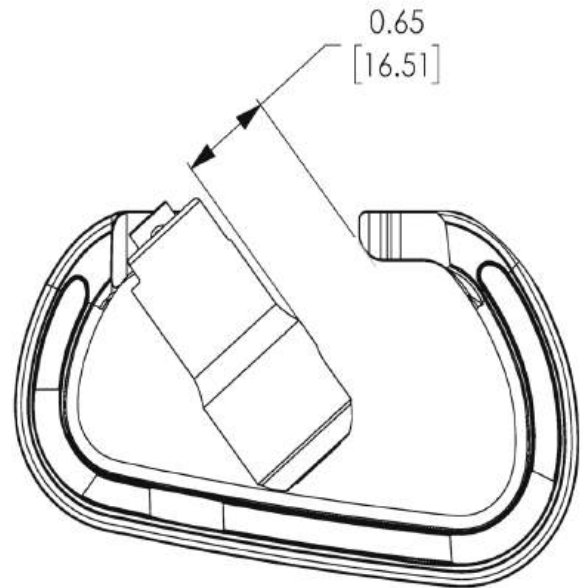

Non-Offset

Feature:

Offset version allows as much as 40% additional opening which increases the working area and facilitates keeping the users hand out of the way of the gate opening

GATE MECHANISMS

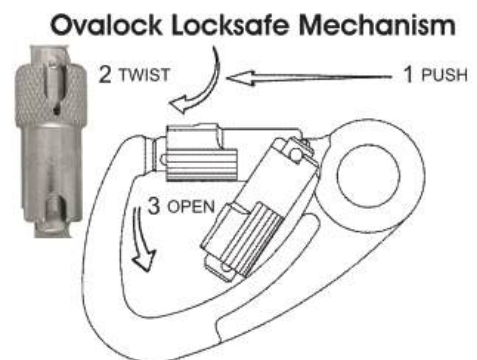
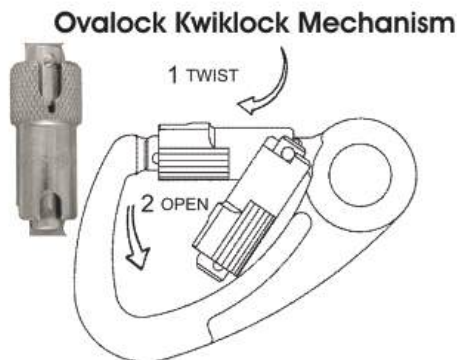
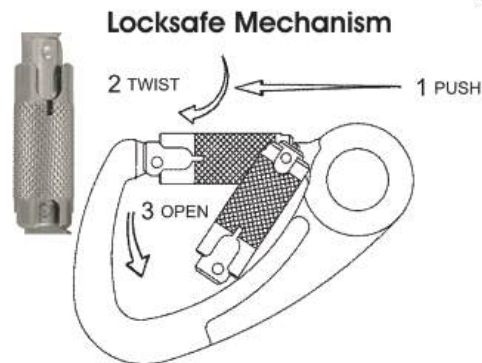
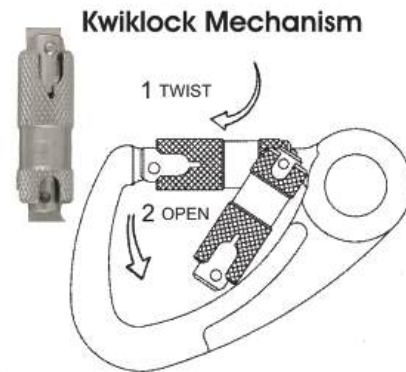
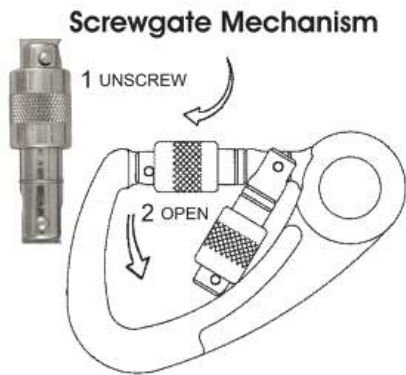

Ovalock Gate System:

When used on a steel carabiner, this steel system is capable of withstanding a minimum load of 5,000 lbs (22.2kN) when applied to any point along the gate. This gate will also meet the requirements of the ANSI/ASSP Z359.12-2019 standard.

Please note that aluminum ovalock gates are not designed as a 5000 lb gate.

(1) Keylock Gate System:

Now available. Contact Customer Service for Details.

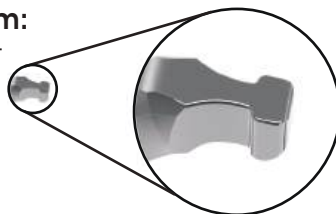

(2) Hybrid Gate System:

Now available. Contact Customer Service for Details.

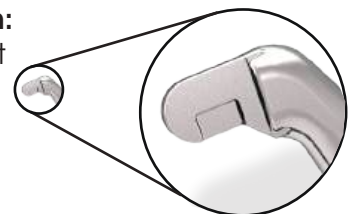

CAPTIVE BARS

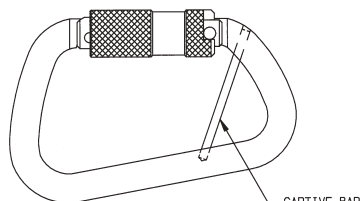

Captive Bars:

Carabiners can be supplied cross-drilled to accommodate Captive Bars. **The Captive Bars are not for load bearing use.** To order use Part Number + "M." Call for details.

CARABINERS

C415



Specifications

- C415 Kwiklock Carabiner
- Cold Formed Steel
- 100% proof loaded to 3,600 lbs (16kN)
- Min tensile strength 6,750 lbs (30kN)
- Min gate strength 3,600 lbs (16kN)
- Min side load strength 3,600 lbs (16kN)
- Minor axis Strength 3,600 lbs (16kN)
- Captive Bar Available (NOT INSTALLED)

Certified To:

- ANSI/ASSP Z359.12-2019
- CSA Z259.12-16
- EN362-2004

Weight: 6.3oz (178gm)

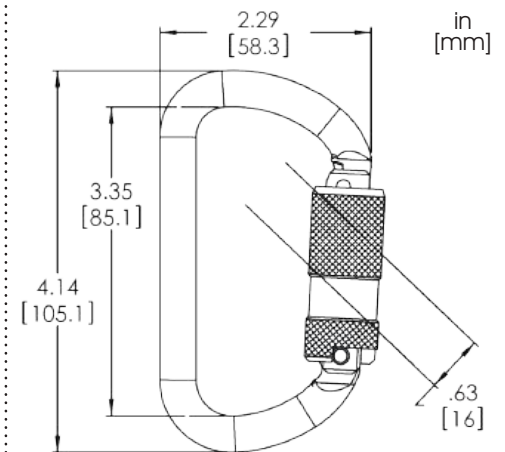

C455



Specifications

- C455 Keylock Kwiklock Carabiner
- Cold Formed Steel
- 100% proof loaded to 3,600 lbs (16kN)
- Min tensile strength 5,000 lbs (22.2kN)
- Min gate strength 3,600 lbs (16kN)
- Min side load strength 3,600 lbs (16kN)
- Minor axis Strength 3,600 lbs (16kN)

Meets or Exceeds:

- ANSI/ASSP Z359.12-2019
- CSA Z259.12-16

Weight: 7.7oz (218gm)

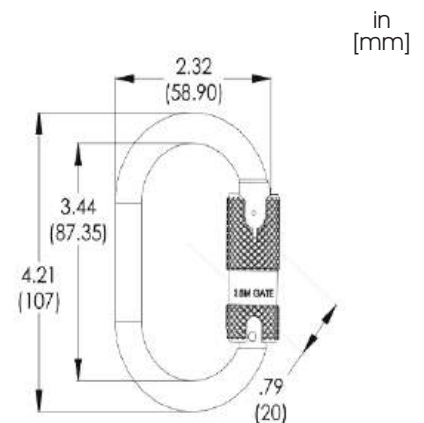

C812PS



Specifications

- C812PS Screwgate Carabiner
- Cold Formed Steel
- 100% proof loaded to 3,600 lbs (16kN)
- Min tensile strength 10,000 lbs (45kN)

Meets or Exceeds:

- EN362-2004

Weight: 8.4oz (238gm)

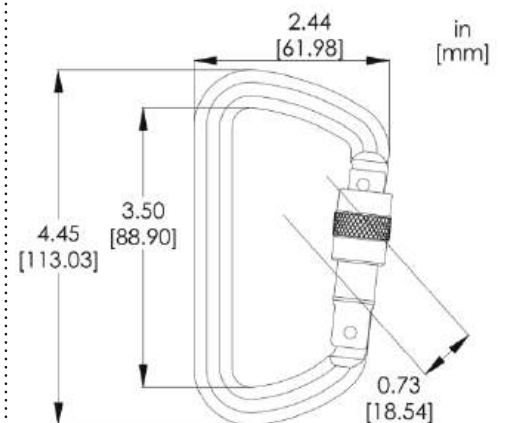

C813PS



Specifications

- C813PS Kwiklock Carabiner
- Cold Formed Steel
- 100% proof loaded to 3,600 lbs (16kN)
- Min tensile strength 10,000 lbs (45kN)
- Min gate strength 3,600 lbs (16kN)
- Min side load strength 3,600 lbs (16kN)
- Minor axis Strength 3,600 lbs (16kN)

Certified To:

- ANSI/ASSP Z359.12-2019
- CSA Z259.12-16

Weight: 9.9oz (281gm)

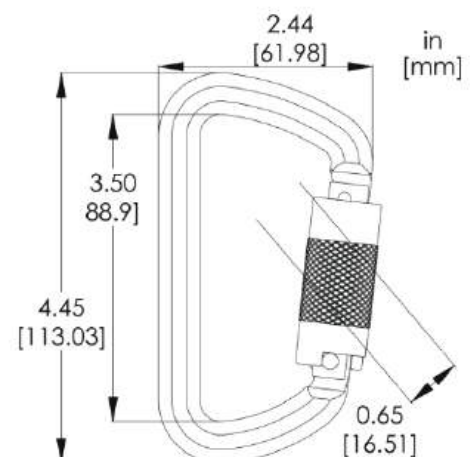

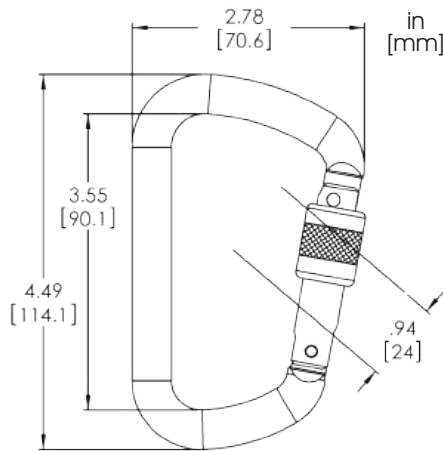

Specifications

- C772 Screwgate Carabiner
- Cold Formed Steel
- 100% proof loaded to 3,600 lbs (16kN)
- Min tensile strength 10,000 lbs (45kN)
- Meets Or Exceeds:
- EN362-2004

Weight: 9.2oz (260gm)

C772

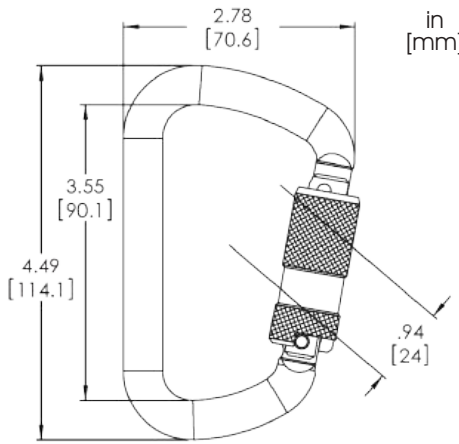

Specifications

- C775 Kwiklock Carabiner
- Cold Formed Steel
- 100% proof loaded to 3,600 lbs (16kN)
- Min tensile strength 10,000 lbs (45kN)
- Min gate strength 3,600 lbs (16kN)
- Min side load strength 3,600 lbs (16kN)
- Minor axis Strength 3,600 lbs (16kN)
- Captive Bar Available (NOT INSTALLED)
- Certified To:
- ANSI/ASSP Z359.12-2019
- CSA Z259.12-16
- EN362-2004

Weight: 10.1oz (285gm)

C775

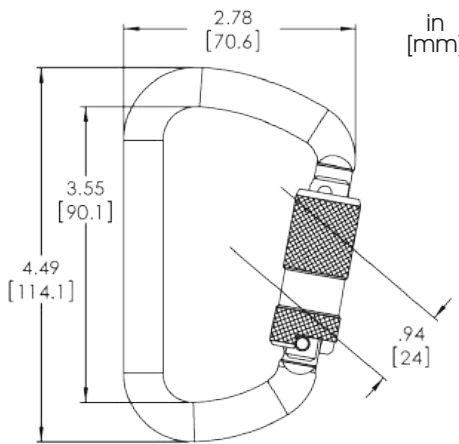

Specifications

- C777 Locksafe (Triple Action) Carabiner
- Cold Formed Steel
- 100% proof loaded to 3,600 lbs (16kN)
- Min tensile strength 10,000 lbs (45kN)
- Min gate strength 3,600 lbs (16kN)
- Min side load strength 3,600 lbs (16kN)
- Minor axis Strength 3,600 lbs (16kN)
- Captive Bar Available (NOT INSTALLED)
- Certified To:
- ANSI/ASSP Z359.12-2019
- CSA Z259.12-16
- EN362-2004

Weight: 10.1oz (285gm)

C777

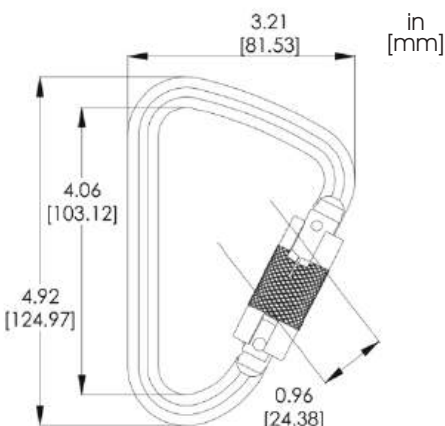

Specifications

- C843PS Kwiklock Carabiner
- Cold Formed Steel
- 100% proof loaded to 3,600 lbs (16kN)
- Min tensile strength 10,000 lbs (45kN)
- Min gate strength 3,600 lbs (16kN)
- Min side load strength 3,600 lbs (16kN)
- Minor axis Strength 3,600 lbs (16kN)
- Captive Bar Available (NOT INSTALLED)
- Certified To:
- ANSI/ASSP Z359.12-2019
- CSA Z259.12-16

Weight: 9.9oz (281gm)

C843PS



CARABINERS

C847PS



Specifications

- C847PS Locksafe (Triple Action) Carabiner
- Cold Formed Steel
- 100% proof loaded to 3,600 lbs (16kN)
- Min tensile strength 10,000 lbs (45kN)
- Min gate strength 3,600 lbs (16kN)
- Min side load strength 3,600 lbs (16kN)
- Minor axis Strength 3,600 lbs (16kN)
- Captive Bar Available (NOT INSTALLED)

Certified To:

- ANSI/ASSP Z359.12-2019
- CSA Z259.12-16

Weight: 9.9oz (281gm)

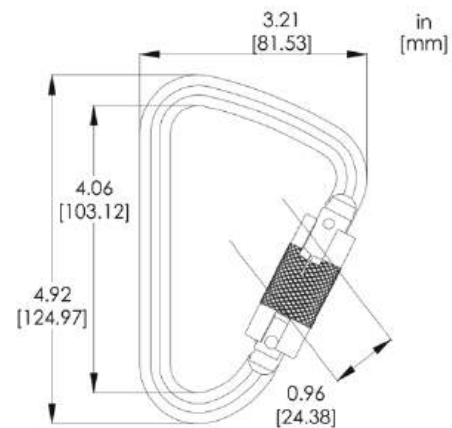

C763PS



Specifications

- C763PS Kwiklock Offset Scaffold Hook
- Cold Formed Steel
- 100% proof loaded to 3,600 lbs (16kN)
- Min tensile strength 9,000 lbs (40kN)
- Min gate strength 3,600 lbs (16kN)
- Min side load strength 3,600 lbs (16kN)
- Minor axis Strength 3,600 lbs (16kN)
- With Captive Bar Only (NOT INSTALLED)

Certified To:

- ANSI/ASSP Z359.12-2019
- CSA Z259.12-16

Weight: 15.9oz (451gm)

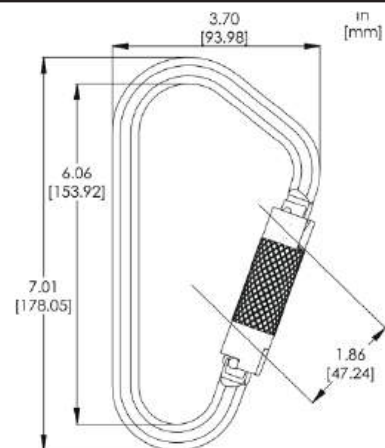

C714PS



Specifications

- C714PS Kwiklock Scaffold Hook
- Cold Formed Steel
- 100% proof loaded to 3,600 lbs (16kN)
- Min tensile strength 10,000 lbs (45kN)
- Min gate strength 3,600 lbs (16kN)
- Min side load strength 3,600 lbs (16kN)
- Minor axis Strength 3,600 lbs (16kN)
- With Captive Bar Only (NOT INSTALLED)

Certified To:

- ANSI/ASSP Z359.12-2019
- CSA Z259.12-16

Weight: 28.1oz (797gm)

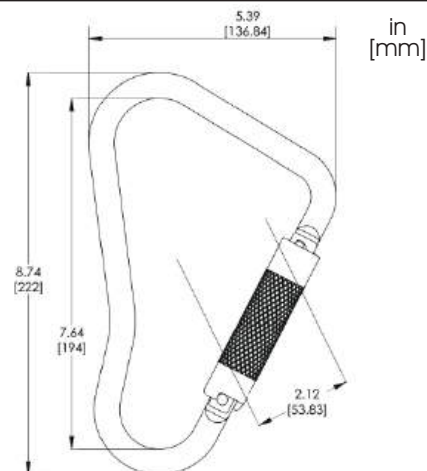

C734PS



Specifications

- C734PS Kwiklock Scaffold Hook
- Cold Formed Steel
- 100% proof loaded to 3,600 lbs (16kN)
- Min tensile strength 8,000 lbs (35kN)
- Min gate strength 3,600 lbs (16kN)
- Min side load strength 3,600 lbs (16kN)
- Minor axis Strength 3,600 lbs (16kN)
- With Captive Bar Only (NOT INSTALLED)

Certified To:

- ANSI/ASSP Z359.12-2019
- EN362: 2004
- CSA Z259.12-16

Weight: 29.7oz (842gm)

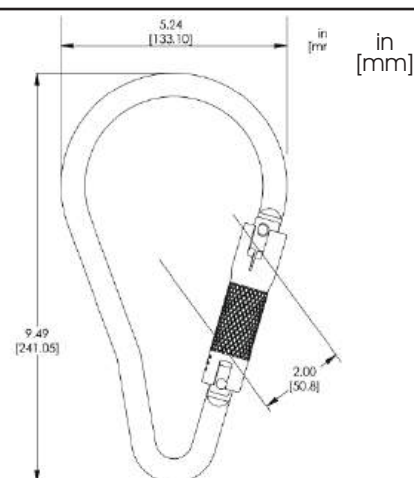

CARABINERS

C335



Specifications

- C335 Hybrid Kwiklock CaptiveEye Carabiner
- Drop Forged Steel
- 100% proof loaded to 3,600 lbs (16kN)
- Min tensile strength 10,000 lbs (45kN)
- Min gate strength 5,000 lbs (22.2kN)
- Min side load strength 5,000 lbs (22.2kN)

Certified To:

- ANSI/ASSP Z359.12-2019
- CSA Z259.12-16
- EN362-2004

Weight: 11.3oz (319gm)

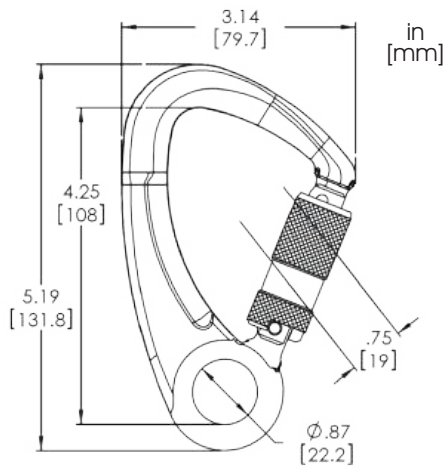

C335-35



Specifications

- C335-35-T Hybrid Kwiklock CaptiveEye Carabiner – PVC Coated
- Drop Forged Steel
- 100% proof loaded to 3,600 lbs (16kN)
- Min tensile strength 10,000 lbs (45kN)
- Min gate strength 5,000 lbs (22.2kN)
- Min side load strength 5,000 lbs (22.2kN)

Certified To:

- ANSI/ASSP Z359.12-2019
- CSA Z259.12-16
- EN362-2004

Weight: 11.8oz (335gm)



C332



Specifications

- C332 Screwgate CaptiveEye Carabiner
- Drop Forged Steel
- 100% proof loaded to 3,600 lbs (16kN)
- Min tensile strength 10,000 lbs (45kN)

Certified To:

- EN362-2004

Weight: 9.6oz (269gm)

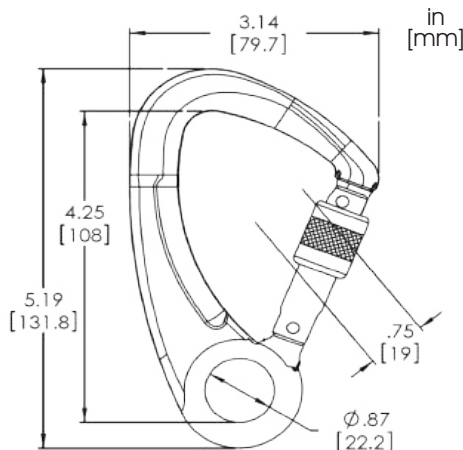

A333PS



Specifications

- A333PS Keylock Kwiklock Carabiner
- Drop Forged Aluminum
- 100% proof loaded to 3,600 lbs (16kN)
- Min tensile strength 6,730 lbs (30kN)
- Min gate strength 3,600 lbs (16kN)
- Min side load strength 3,600 lbs (16kN)
- Minor axis strength 3,600 lbs (16kN)
- Captive Bar Available (NOT INSTALLED)

Certified To:

- ANSI/ASSP Z359.12-2019
- CSA Z259.12-16
- NFPA 2500 (1983), 2022 ED

Weight: 3.5oz (99gm)

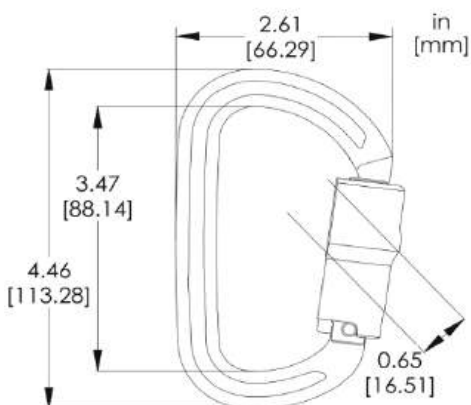

CARABINERS

A353PS



Specifications

- A353PS Keylock Offset Kwiklock Carabiner
- Drop Forged Aluminum
- 100% proof loaded to 3,600 lbs (16kN)
- Min tensile strength 6,730 lbs (30kN)
- Min gate strength 3,600 lbs (16kN)
- Min side load strength 3,600 lbs (16kN)
- Minor axis strength 3,600 lbs (16kN)
- Captive Bar Available (NOT INSTALLED)

Certified To:

- ANSI/ASSP Z359.12-2019
- CSA Z259.12-16
- NFPA 2500 (1983), 2022 ED

Weight: 4.1oz (116.9gm)

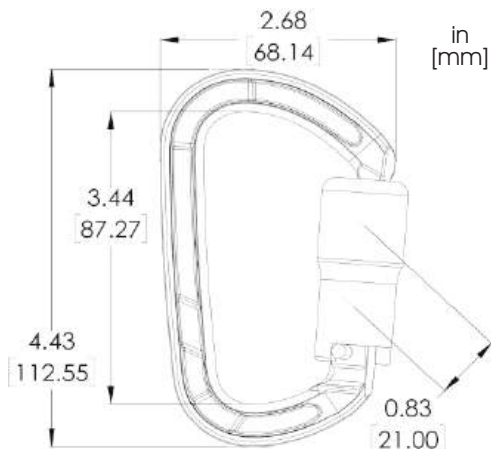

A337PS



Specifications

- A337PS Locksafe (Triple Action) Carabiner
- Drop Forged Aluminum
- 100% proof loaded to 3,600 lbs (16kN)
- Min tensile strength 6,730 lbs (30kN)
- Min gate strength 3,600 lbs (16kN)
- Min side load strength 3,600 lbs (16kN)
- Minor axis strength 3,600 lbs (16kN)
- Captive Bar Available (NOT INSTALLED)

Certified To:

- ANSI/ASSP Z359.12-2019
- CSA Z259.12-16
- NFPA 2500 (1983), 2022 ED

Weight: 3.5oz (99gm)

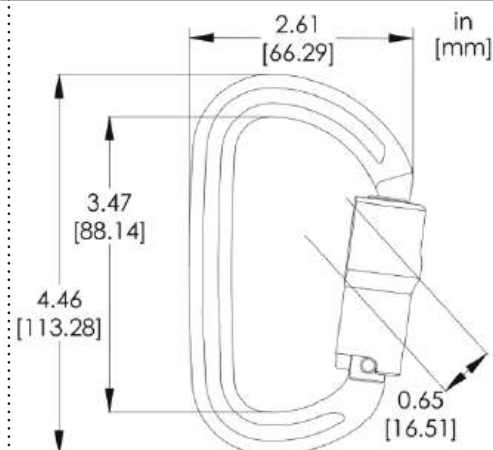

A357PS



Specifications

- A357PS Locksafe Offset (Triple Action) Carabiner
- Drop Forged Aluminum
- 100% proof loaded to 3,600 lbs (16kN)
- Min tensile strength 6,730 lbs (30kN)
- Min gate strength 3,600 lbs (16kN)
- Min side load strength 3,600 lbs (16kN)
- Minor axis strength 3,600 lbs (16kN)
- Captive Bar Available (NOT INSTALLED)

Certified To:

- ANSI/ASSP Z359.12-2019
- CSA Z259.12-16
- NFPA 2500 (1983), 2022 ED

Weight: 4.1oz (116.9gm)

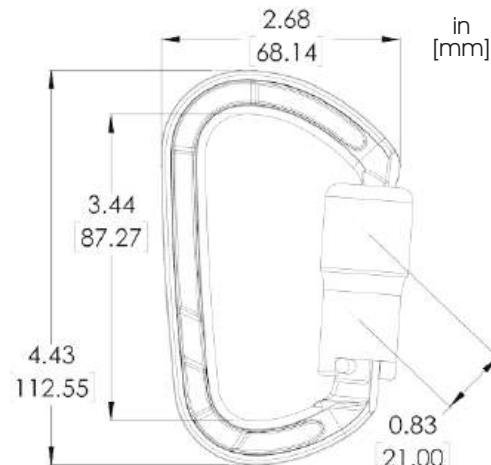

A393PS-26 kN



Specifications

- A393PS Kwiklock Oval Offset Carabiner
- Drop Forged Aluminum
- 100% proof loaded to 3,600 lbs (16kN)
- Min tensile strength 5,485 lbs (26kN)
- Min gate strength 3,600 lbs (16kN)
- Min side load strength 3,600 lbs (16kN)
- Minor axis strength 3,600 lbs (16kN)

Certified To:

- ANSI/ASSP Z359.12-2019
- CSA Z259.12-16
- NFPA 2500 (1983), 2022 ED

Weight: 4.0oz (113gm)

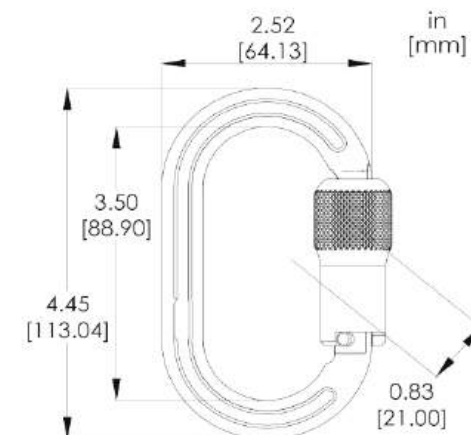

CARABINERS

A393PS-30 kN



Specifications

- A393PS Kwiklock Oval Offset Carabiner
- Drop Forged Aluminum
- 100% proof loaded to 3,600 lbs (16kN)
- Min tensile strength 6,730 lbs (30kN)
- Min gate strength 3,600 lbs (16kN)
- Min side load strength 3,600 lbs (16kN)
- Minor axis strength 3,600 lbs (16kN)

Certified To:

- ANSI/ASSP Z359.12-2019
- CSA Z259.12-16
- NFPA 2500 (1983), 2022 ED

Weight: 4.5oz (128gm)

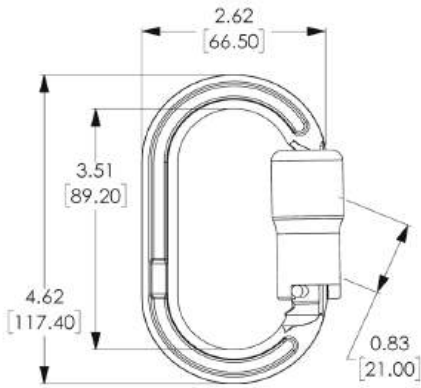

A397PS- 26 kN



Specifications

- A397PS Locksafe (Triple Action) Oval Offset Carabiner
- Drop Forged Aluminum
- 100% proof loaded to 3,600 lbs (16kN)
- Min tensile strength 5,485 lbs (26kN)
- Min gate strength 3,600 lbs (16kN)
- Min side load strength 3,600 lbs (16kN)
- Minor axis strength 3,600 lbs (16kN)

Certified To:

- ANSI/ASSP Z359.12-2019
- CSA Z259.12-16
- NFPA 2500 (1983), 2022 ED

Weight: 4.0oz (113gm)

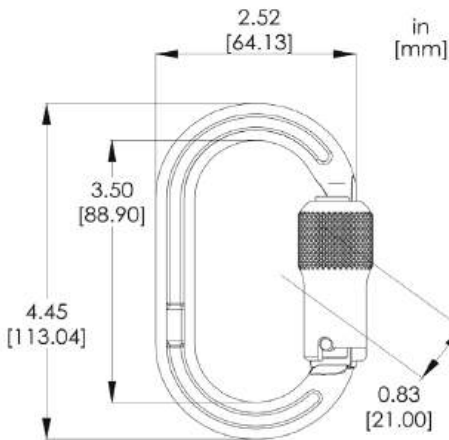

A397PS- 30 kN



Specifications

- A397PS Locksafe (Triple Action) Oval Offset Carabiner
- Drop Forged Aluminum
- 100% proof loaded to 3,600 lbs (16kN)
- Min tensile strength 6,730 lbs (30kN)
- Min gate strength 3,600 lbs (16kN)
- Min side load strength 3,600 lbs (16kN)
- Minor axis strength 3,600 lbs (16kN)

Certified To:

- ANSI/ASSP Z359.12-2019
- CSA Z259.12-16
- NFPA 2500 (1983), 2022 ED

Weight: 4.5oz (128gm)

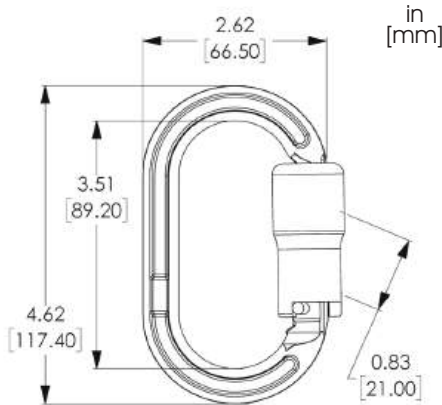

A843PS



Specifications

- A843PS Keylock Kwiklock Carabiner
- Drop Forged Aluminum
- 100% proof loaded to 3,600 lbs (16kN)
- Min tensile strength 6,730 lbs (30kN)
- Min gate strength 3,600 lbs (16kN)
- Min side load strength 3,600 lbs (16kN)
- Minor axis strength 3,600 lbs (16kN)
- Captive Bar Available (NOT INSTALLED)

Certified To:

- ANSI/ASSP Z359.12-2019
- CSA Z259.12-16
- EN362-2004

Weight: 4.0oz (113gm)

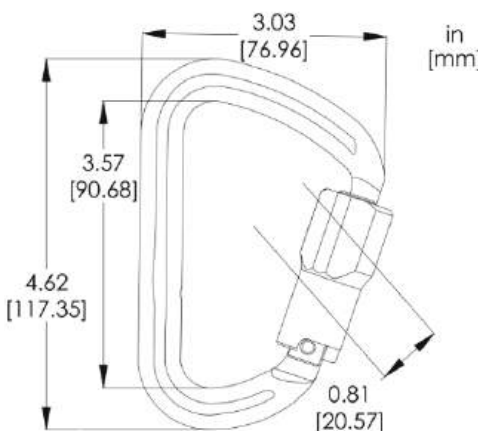

CARABINERS

A853PS



Specifications

- A853 Keylock Offset Kwiklock Carabiner
- Drop Forged Aluminum
- 100% proof loaded to 3,600 lbs (16kN)
- Min tensile strength 6,730 lbs (30 kN)
- Min gate strength 3,600 lbs (16kN)
- Min side load strength 3,600 lbs (16 kN)
- Minor axis strength 3,600 lbs (16 kN)
- Captive Bar Available (NOT INSTALLED)

Certified To:

- ANSI/ASSP Z359.12-2019
- CSA Z259.12-16
- NFPA 2500 (1983) 2022 ED

Weight: 4.1oz (116.9 gm)

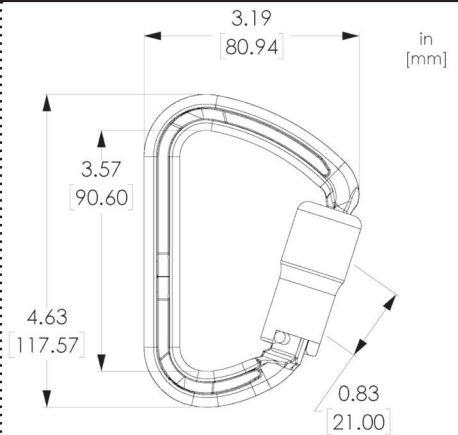

A847PS



Specifications

- A847PS Locksafe (Triple Action) Carabiner
- Drop Forged Aluminum
- 100% proof loaded to 3,600 lbs (16kN)
- Min tensile strength 6,730 lbs (30kN)
- Min gate strength 3,600 lbs (16kN)
- Min side load strength 3,600 lbs (16kN)
- Minor axis strength 3,600 lbs (16kN)
- Captive Bar Available (NOT INSTALLED)

Certified To:

- ANSI/ASSP Z359.12-2019
- CSA Z259.12-16

Weight: 4.0oz (113gm)

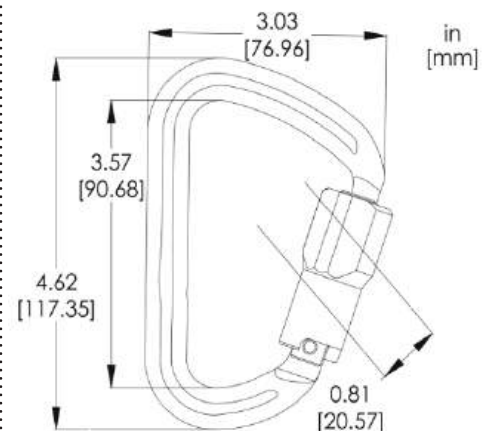

A857PS



Specifications

- A857 Locksafe Offset (Triple Action) Keylock Carabiner
- Drop Forged Aluminum
- 100% proof loaded to 3,600 lbs (16kN)
- Min tensile strength 6,730 lbs (30 kN)
- Min gate strength 3,600 lbs (16kN)
- Min side load strength 3,600 lbs (16 kN)
- Minor axis strength 3,600 lbs (16 kN)
- Captive Bar Available (NOT INSTALLED)

Certified To:

- ANSI/ASSP Z359.12-2019
- CSA Z259.12-16
- NFPA 2500 (1983) 2022 ED

Weight: 4.1oz (116.9 gm)

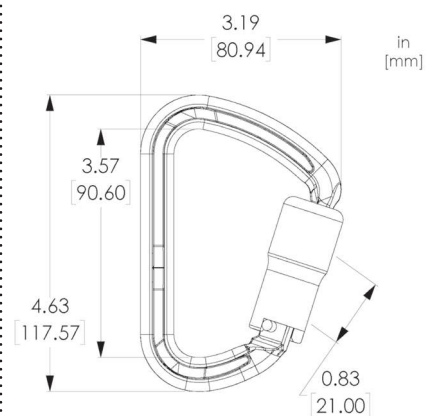

A903PS



Specifications

- A903PS Keylock Kwiklock Carabiner
- Drop Forged Aluminum
- 100% proof loaded to 3,600 lbs (16kN)
- Min tensile strength 6,730 lbs (30kN)
- Min gate strength 3,600 lbs (16kN)
- Min side load strength 3,600 lbs (16kN)
- Minor axis strength 3,600 lbs (16kN)
- Captive Bar Available (NOT INSTALLED)

Certified To:

- ANSI/ASSP Z359.12-2019
- CSA Z259.12-16
- EN362-2004

Weight: 4.3oz (122gm)

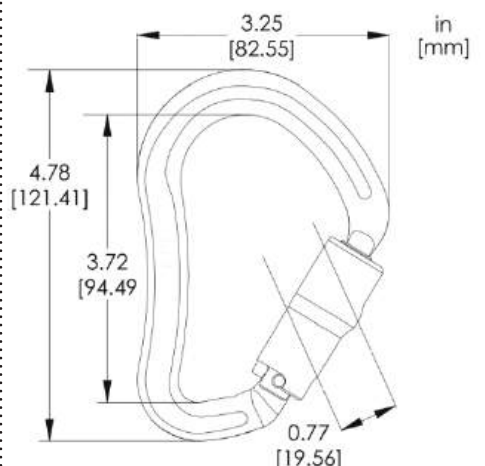

CARABINERS

A953PS



Specifications

- A953 Keylock Offset Kwiklock Carabiner
- Drop Forged Aluminum
- 100% proof loaded to 3,600 lbs (16kN)
- Min tensile strength 6,730 lbs (30 kN)
- Min gate strength 3,600 lbs (16kN)
- Min side load strength 3,600 lbs (16 kN)
- Minor axis strength 3,600 lbs (16 kN)
- Captive Bar Available (NOT INSTALLED)

Certified To:

- ANSI/ASSP Z359.12-2019
- CSA Z259.12-16
- NFPA 2500 (1983) 2022 ED

Weight: 4.1oz (116.9 gm)

A907PS



Specifications

- A907PS Locksafe (Tripe Action) Carabiner
- Drop Forged Aluminum
- 100% proof loaded to 3,600 lbs (16kN)
- Min tensile strength 6,730 lbs (30kN)
- Min gate strength 3,600 lbs (16kN)
- Min side load strength 3,600 lbs (16kN)
- Minor axis strength 3,600 lbs (16kN)
- Captive Bar Available (NOT INSTALLED)

Certified To:

- ANSI/ASSP Z359.12-2019
- CSA Z259.12-16
- EN362-2004

Weight: 4.3oz (122gm)

A957PS



Specifications

- A957 Locksafe Offset (Triple Action) Keylock Carabiner
- Drop Forged Aluminum
- 100% proof loaded to 3,600 lbs (16kN)
- Min tensile strength 6,730 lbs (30 kN)
- Min gate strength 3,600 lbs (16kN)
- Min side load strength 3,600 lbs (16 kN)
- Minor axis strength 3,600 lbs (16 kN)
- Captive Bar Available (NOT INSTALLED)

Certified To:

- ANSI/ASSP Z359.12-2019
- CSA Z259.12-16
- NFPA 2500 (1983) 2022 ED

Weight: 4.1oz (116.9 gm)

A913PS



Specifications

- A913PS Keylock Kwiklock Carabiner
- Drop Forged Aluminum
- 100% proof loaded to 3,600 lbs (16kN)
- Min tensile strength 6,730 lbs (30kN)
- Min gate strength 3,600 lbs (16kN)
- Min side load strength 3,600 lbs (16kN)
- Minor axis strength 3,600 lbs (16kN)

Certified To:

- ANSI/ASSP Z359.12-2019
- CSA Z259.12-16
- EN362-2004
- NFPA 2500 (1983), 2022 ED

Weight: 4.3oz (122gm)

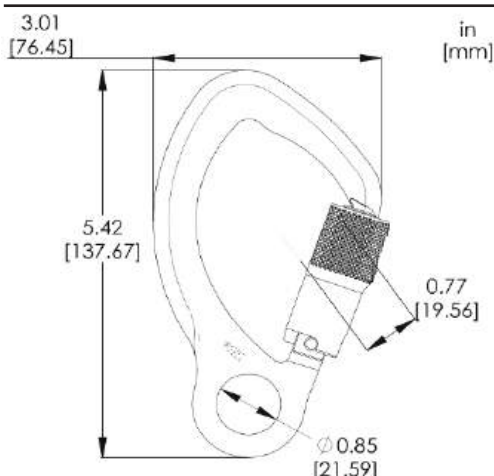
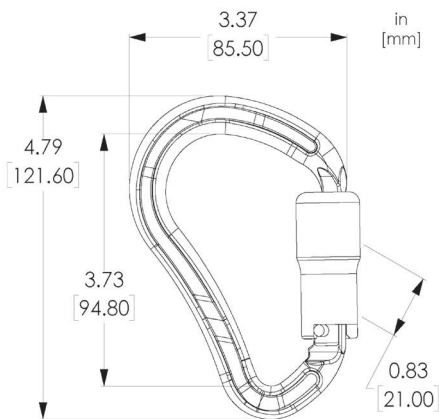
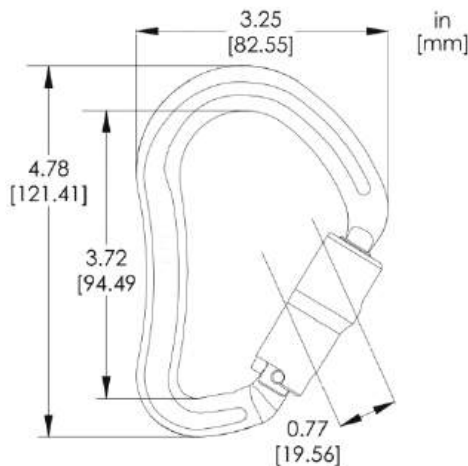
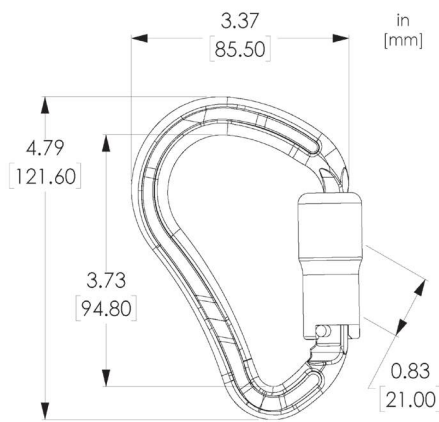

CARABINERS

A973PS



Specifications

- A973 Keylock Offset Kwiklock Carabiner
- Drop Forged Aluminum
- 100% proof loaded to 3,600 lbs (16kN)
- Min tensile strength 6,730 lbs (30 kN)
- Min gate strength 3,600 lbs (16kN)
- Min side load strength 3,600 lbs (16 kN)
- Minor axis strength 3,600 lbs (16 kN)
- Captive Bar Available (NOT INSTALLED)

Certified To:

- ANSI/ASSP Z359.12-2019
- CSA Z259.12-16
- NFPA 2500 (1983) 2022 ED

Weight: 4.1oz (116.9 gm)

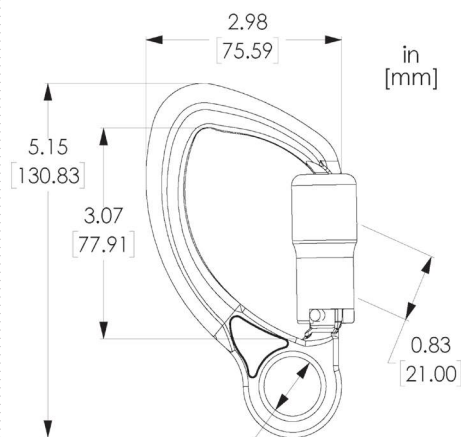

A917PS



Specifications

- A917PS Locksafe (Tripe Action) Carabiner
- Drop Forged Aluminum
- 100% proof loaded to 3,600 lbs (16kN)
- Min tensile strength 6,730 lbs (30kN)
- Min gate strength 3,600 lbs (16kN)
- Min side load strength 3,600 lbs (16kN)
- Minor axis strength 3,600 lbs (16kN)

Certified To:

- ANSI/ASSP Z359.12-2019
- CSA Z259.12-16
- EN362-2004
- NFPA 2500 (1983), 2022 ED

Weight: 4.3oz (122gm)

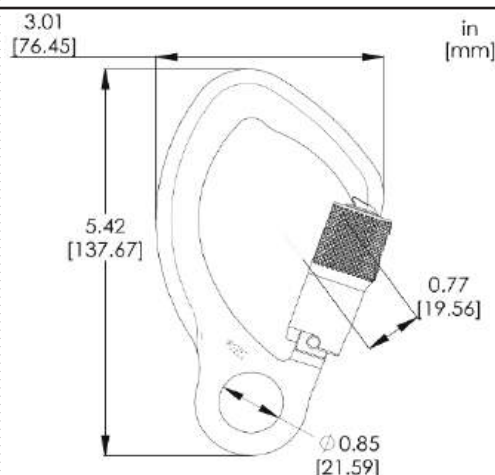

A977PS



Specifications

- A977 Locksafe Offset (Triple Action) Keylock Carabiner
- Drop Forged Aluminum
- 100% proof loaded to 3,600 lbs (16kN)
- Min tensile strength 6,730 lbs (30 kN)
- Min gate strength 3,600 lbs (16kN)
- Min side load strength 3,600 lbs (16 kN)
- Minor axis strength 3,600 lbs (16 kN)
- Captive Bar Available (NOT INSTALLED)

Certified To:

- ANSI/ASSP Z359.12-2019
- CSA Z259.12-16
- NFPA 2500 (1983) 2022 ED

Weight: 4.1oz (116.9 gm)

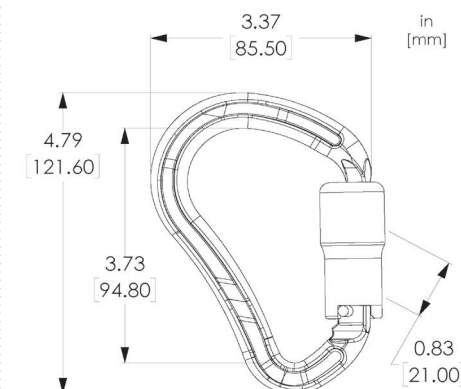

A1187



Specifications

- A1187 Locksafe Offset (Triple Action) Keylock Carabiner
- Drop Forged Aluminum
- 100% proof loaded to 3,600 lbs (16kN)
- Min tensile strength 6,730 lbs (30 kN)
- Min gate strength 3,600 lbs (16kN)
- Min side load strength 3,600 lbs (16 kN)
- Minor axis strength 3,600 lbs (16 kN)
- Captive Bar Available (NOT INSTALLED)

Certified To:

- ANSI/ASSP Z359.12-2019
- NFPA 2500 (1983) 2022 ED

Meets or exceeds:

- CSA Z259.12-16

Weight: 4.1oz (116.9 gm)

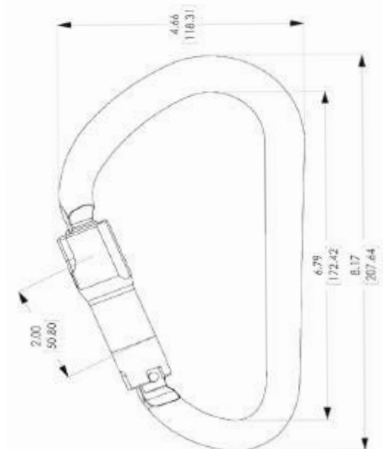

LIFTING CARABINERS/QUICK RIGGING CONNECTORS

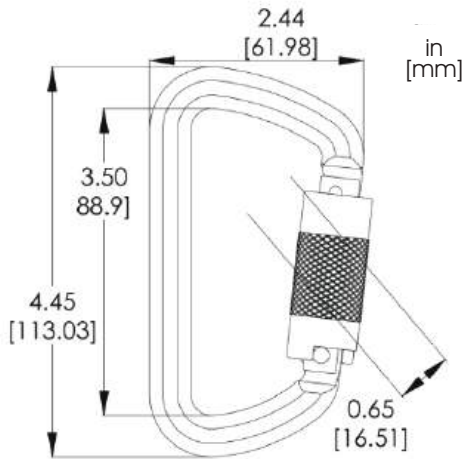

Specifications

- C813L Kwiklock Lifting Carabiner/ Quick Rigging Connector (QRC)
- Cold Formed Steel
- 100% proof loaded to 3,600 lbs (16kN)
- Major Axis (Inline) Load 2000 lbs or 1/5 of the ultimate tensile load (10,000lbs)
- Triaxial Working Load Limit (WLL) 700 lbs or 1/5 of ultimate gate strength
- Available with Captive Bar

Weight: 9.9oz (281gm)

C813L

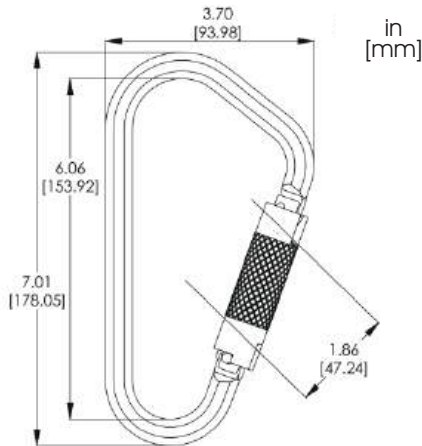

Specifications

- C763L Kwiklock Lifting Carabiner/ Quick Rigging Connector (QRC)
- Cold Formed Steel
- 100% proof loaded to 3,600 lbs (16kN)
- Major Axis (Inline) Load 2000 lbs or 1/5 of the ultimate tensile load (10,000lbs)
- Triaxial Working Load Limit (WLL) 800 lbs or 1/5 of ultimate gate strength
- Available with Captive Bar Only (NOT INSTALLED)

Weight: 15.9oz (451gm)

C763L

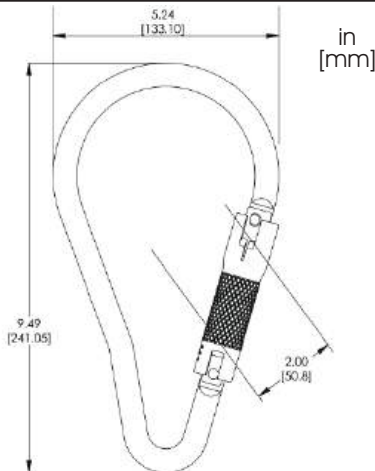

Specifications

- C734L Kwiklock Lifting Hook/ Quick Rigging Connector (QRC)
- Cold Formed Steel
- 100% proof loaded to 3,600 lbs (16kN)
- Major Axis (Inline) Load 1600 lbs or 1/5 of the ultimate tensile load (8,000lbs)
- Triaxial Working Load Limit (WLL) 900 lbs or 1/5 of ultimate gate strength
- Available with Captive Bar Only (NOT INSTALLED)

Weight: 29.7oz (842gm)

C734L



***The finish for the lifting carabiners / Quick Rigging Connector (QRC) is a black e-coat. These are marked with a Major Axis (Inline) Load which is 1/5 of the ultimate tensile load as well a Triaxial Working Load Limit (WLL) which is 1/5 of ultimate gate strength. Other body styles could be done as a lifting carabiner (Please inquire for more information.)

Note that PPE should not be used for lifting materials of any kind.

ANCHORAGE CONNECTORS

COMPATIBILITY OF LOCKING SNAP HOOKS WITH ANCHORAGE CONNECTORS

Locking snap hooks should always be used with compatible anchorage connectors. It is strongly recommended that:

1. The design of the anchorage connector must be such that no dynamic force is applied to the keeper system of the locking snap hook (see Figures 1 and 2).
2. The anchorage connector system should be configured such that the locking snap hook will self-correct under dynamic loading. The anchorage connector system should never be configured such that dynamic loading could be placed on the keeper system.
3. The entire base of the anchorage connector system must be flush with the mounting surface (see Figure 3).
4. The area of the mounting surface for the anchorage connector must be such that no dynamic forces can be placed on the keeper system (see Figure 3).

It is the responsibility of the purchaser to ensure that any component utilized is compatible within the system designed and with other components that may be used in conjunction.

NOTE: 3731, 3732 and 3742 are tested to the three vector directions; longitudinal, transverse (across the parting line) and straight out.

Example of a compatible connection of a locking snap hook with an appropriate anchorage connector

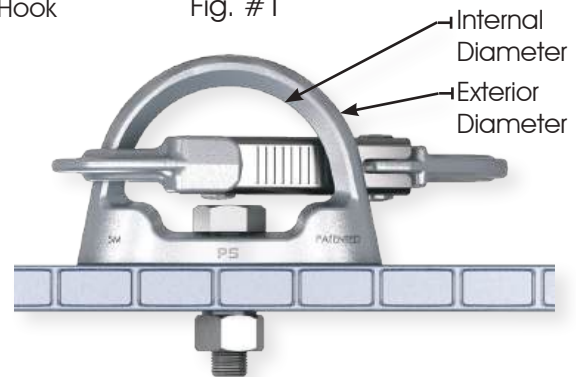
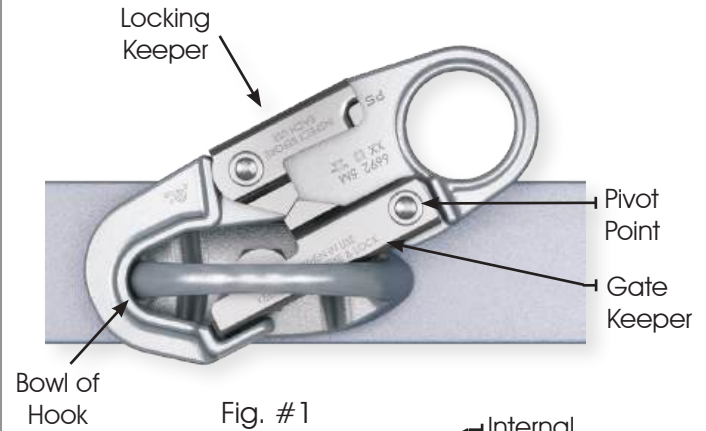
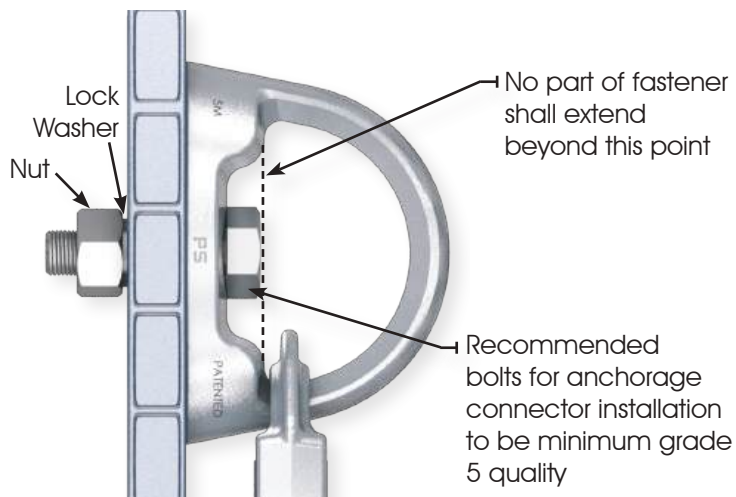

Fig. #2



Recommended Torque Values:

- 65-75 ft-lb for a 1/2" clearance hole (13 TPI Bolt)
- 145-155 ft-lb for a 5/8" clearance hole (11 TPI Bolt)
- 240-250 ft-lb for a 3/4" clearance hole (10 TPI Bolt)

Torque values are laser etched along with requirement for a minimum Grade 5 bolt.

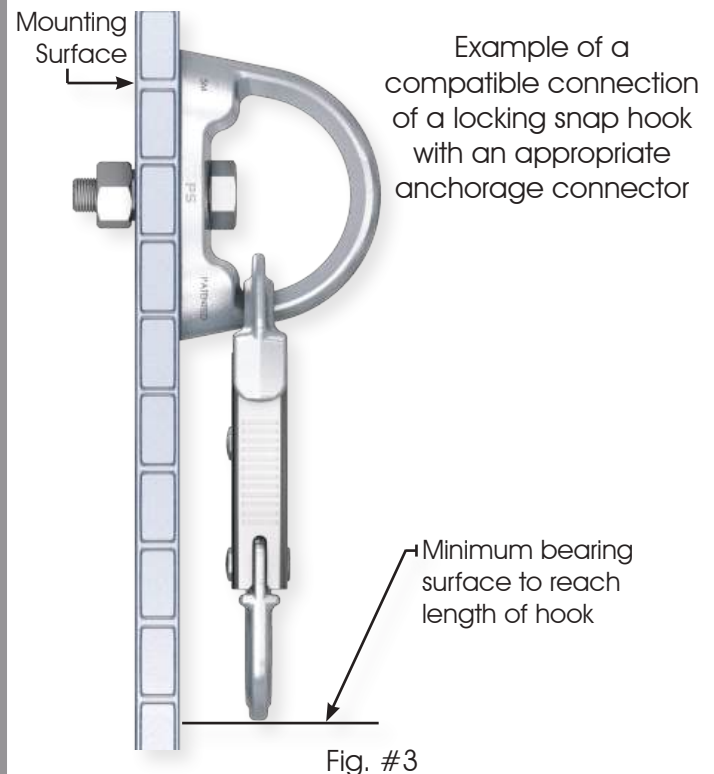
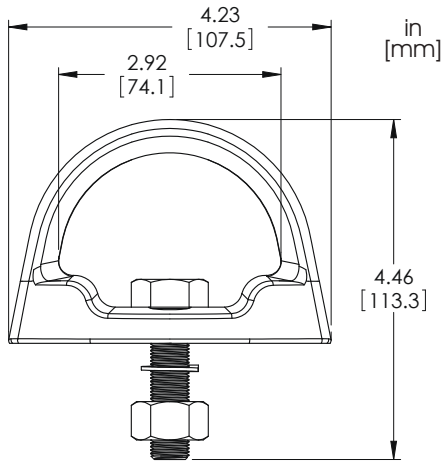

Fig. #3

ANCHORAGE CONNECTORS



Specifications

- 3732 Anchorage Connector
- 1/2" clearance hole
- Drop Forged Steel
- 100% proof loaded to 3,600 lbs (16kN)
- Min tensile strength 5,000 lbs (22.2kN)
- Assembly includes a grade 5 structural bolt with nut and lock washer.
- Recommended torque values:
 - 65-75 ft-lb for a 1/2" clearance hole (13 TPI bolt).

Weight: 20.5oz (580gm)

3731 Assembly

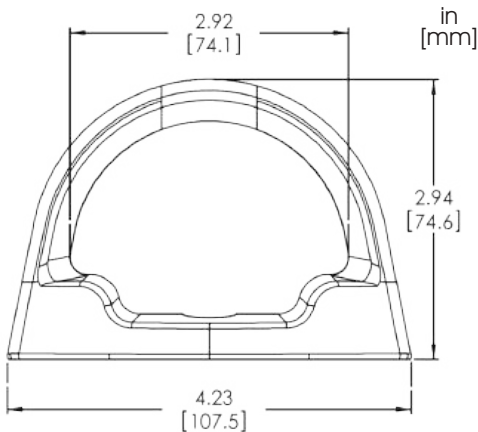

Specifications

- 3732 Anchorage Connector
- Drop Forged Steel
- 100% proof loaded to 3,600 lbs (16kN)
- Min tensile strength 5,000 lbs (22.2kN)
- Recommended bolts for anchorage connector installation to be minimum grade 5 quality with lock washer.
- Recommended torque values:
 - 65-75 ft-lb for a 1/2" clearance hole (13 TPI bolt).
 - 145-155 ft-lb for a 5/8" clearance hole (11 TPI bolt).
 - 240-250 ft-lb for a 3/4" clearance hole (10 TPI bolt).

Weight: 16oz (450gm)

3732



Image depicted is a 1/2" Anchorage Connector

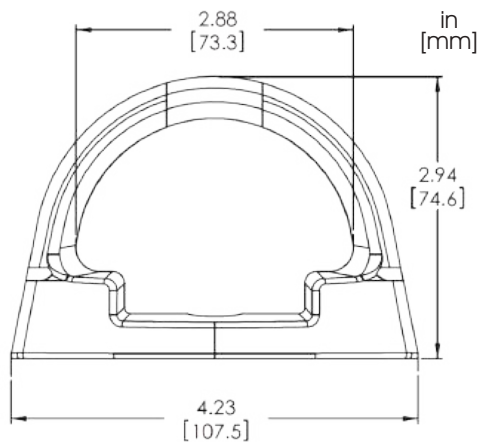

Specifications

- 3742 Anchorage Connector
- Drop Forged Stainless Steel
- 100% proof loaded to 3,600 lbs (16kN)
- 5/8" Min tensile strength 9,000 lbs (40kN)
- 3/4" Min tensile strength 10,000 lbs (44.5kN)
- Only offered in Clear Zinc Nickel to improve corrosion resistance
- Recommended torque values:
 - 90-100 ft-lb for a 5/8" clearance hole (11 TPI grade 316SS bolt)
 - 125-135 ft-lb for a 3/4" clearance (10 TPI 316 SS bolt)

Weight: 16.5oz (468gm)

3742



Image depicted is a 5/8" Anchorage Connector

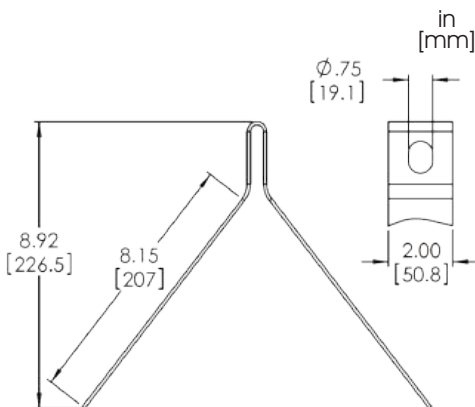

Specifications

- 9780 Disposable Roof Anchor
- Sheet Stamping Steel
- Min tensile strength 5,000 lbs (22.2kN) when attached as per manufacturer specification
- Available with fasteners and instructions

Weight: 18oz (512gm)

9780



Warning:

- All users must read and understand all warnings and instructions.
- Only trained personnel shall use this equipment.
- Ensure that all pieces of equipment are compatible with each other.
- The end user must inspect all equipment before each use.
- A “competent person” as defined by OSHA, must inspect all equipment at least annually.
- In the event of a fall, the equipment must be replaced.
- Do not alter any equipment; any repair can only be performed by the manufacturer or authorized personnel.
- The roof anchor must be installed according to instructions supplied using the appropriate 4” ardox nails for the 9780.
- The user must connect to the anchor point using only approved connecting devices
- Ensure that the connector used is firmly connected through both sides of the connecting loop at the top of the anchor.
- This roof anchor is intended for single attachment only.
- This anchorage connector is intended to be installed on wood framed structures capable of withstanding a minimum of 5,000 lbs (22kN) of loading.
- Additional requirements and specifications are supplied with the roof anchor.

in
[mm]

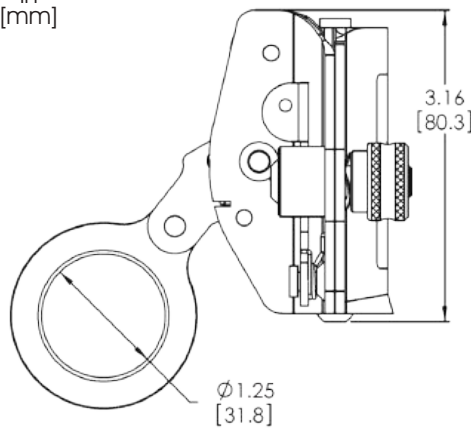

Specifications

- 7360 ADP Rope Grab
 - Cold Formed Steel
 - Min tensile strength 5,000 lbs (22.2kN)
- Certified To:
- pending certification to the updated standards

Weight: 16.2oz (459gm)

7360



Features

- Automatic panic type Rope Grab Class ADP (Automatic Dorsal Panic)
- For use by persons with a combined weight (clothing, tools, etc) of no more than 310 LBS.
- Up arrow.
- Orientation lock out.
- Spring loaded lever.
- Knurl knob.
- Maximum arrest force 1,800 LBS (8kN).
- Maximum stopping distance 39 inches (1 meter).

Compatibility with Vertical Lifeline

1. 5/8" (16mm) Co-Polymer 3-strand braided Rope - Cancord Inc. Part No. 57-316
2. 5/8" (16mm) Low Stretch Nylon Kernmantle Rope - Cancord Inc. Part No. 10-316

FALL ARRESTERS

RGL6030

Certified To:

- pending certification to the updated standards

Compatible Connector List:

- 6692 (Page 6) Example in this picture
- 9692 (Page 6)
- 9695 (Page 6)
- 9697 (Page 6)
- A913PS/A917PS (Page 21)



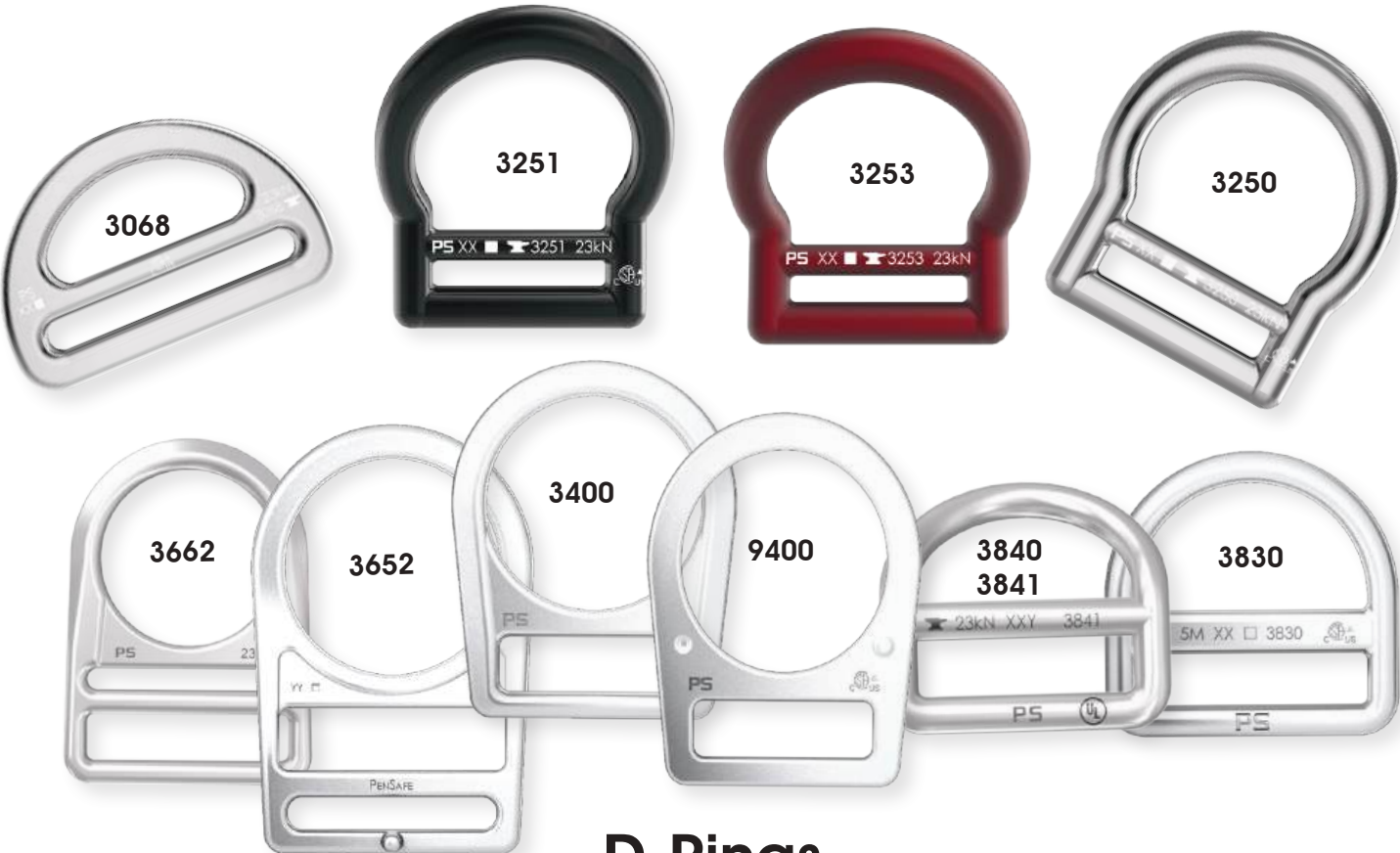

D-Rings



RINGS

3068



Specifications

- 3068 3-1/4" Single Slot D-Ring
- Drop Forged Aluminum
- 100% proof loaded to 3,600 lbs (16kN)
- Min tensile strength 5,000 lbs (22.2kN)

Certified To:

- ANSI/ASSP Z359.12-2019
- CSA Z259.12-16

Weight: 3.6oz (103gm)

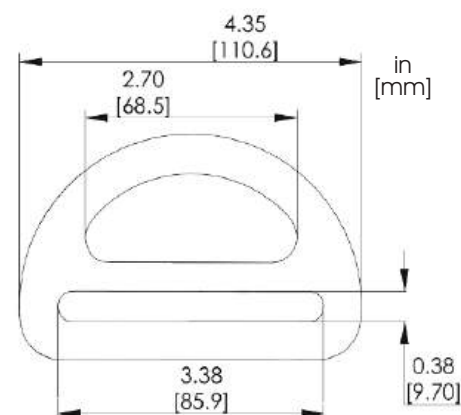

3250



Specifications

- 3250 1-3/4" Single Slot D-Ring Flat
- Drop Forged Aluminum
- 100% proof loaded to 3,600 lbs (16kN)
- Min tensile strength 5,000 lbs (22.2kN)

Certified To:

- ANSI/ASSP Z359.12-2019
- CSA Z259.12-16

Weight: 2.6oz (75gm)

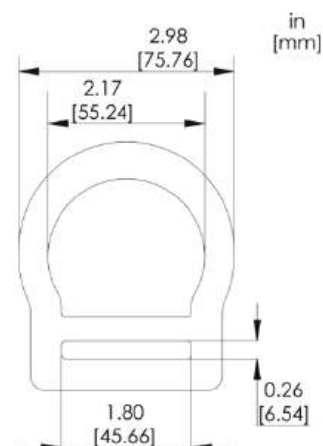

3251



Specifications

- 3251 1-3/4" Single Slot D-Ring Cranked 34 Degree
- Drop Forged Aluminum
- 100% proof loaded to 3,600 lbs (16kN)
- Min tensile strength 5,000 lbs (22.2kN)

Certified To:

- ANSI/ASSP Z359.12-2019
- CSA Z259.12-16

Weight: 2.6oz (75gm)

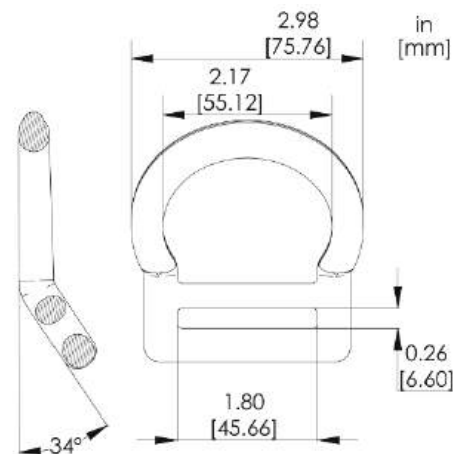

3253



Specifications

- 3253 1-3/4" Single Slot D-Ring Cranked 45 Degree
- Drop Forged Aluminum
- 100% proof loaded to 3,600 lbs (16kN)
- Min tensile strength 5,000 lbs (22.2kN)

Certified To:

- ANSI/ASSP Z359.12-2019
- CSA Z259.12-16

Weight: 2.6oz (75gm)

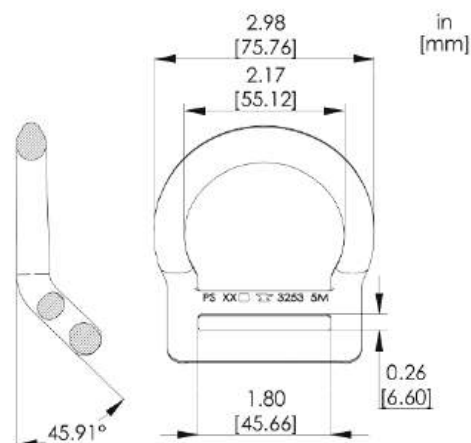

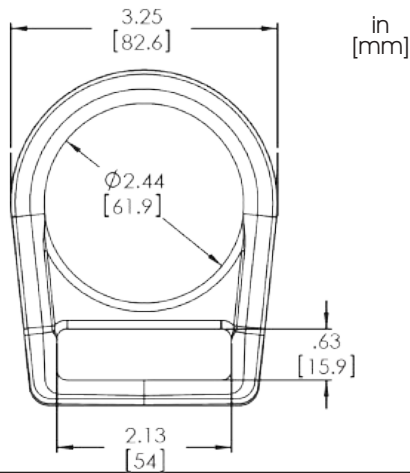

Specifications

- 3400 2 1/8" Single Slot D-Ring
- Drop Forged Steel
- 100% proof loaded to 3,600 lbs (16kN)
- Min tensile strength 5,000 lbs (22.2kN)

Certified To:

- ANSI/ASSP Z359.12-2019
- CSA Z259.12-16

Weight: 6.0oz (168gm)

3400

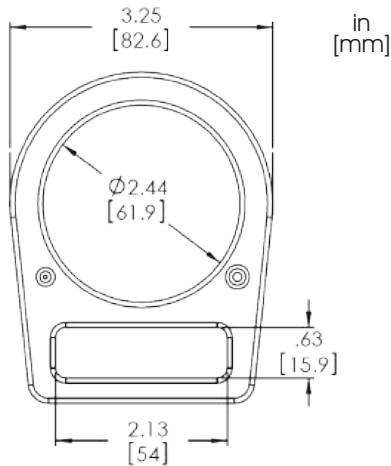

Specifications

- 9400 2 1/8" Single Slot D-Ring
- Sheet Stamping Steel
- 100% proof loaded to 3,600 lbs (16kN)
- Min tensile strength 5,000 lbs (22.2kN)

Certified To:

- ANSI/ASSP Z359.12-2019
- CSA Z259.12-16

Weight: 4.7oz (131gm)

9400

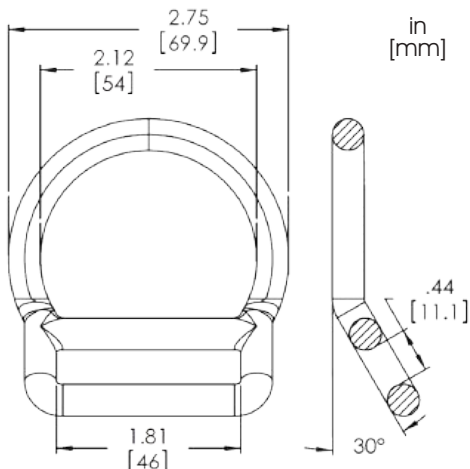

Specifications

- 3221 1 13/16" Single Slot D-Ring
- Drop Forged Steel
- 100% proof loaded to 3,600 lbs (16kN)
- Min tensile strength 5,000 lbs (22.2kN)

Certified To:

- ANSI/ASSP Z359.12-2019
- CSA Z259.12-16

Weight: 3.7oz (104gm)

3221

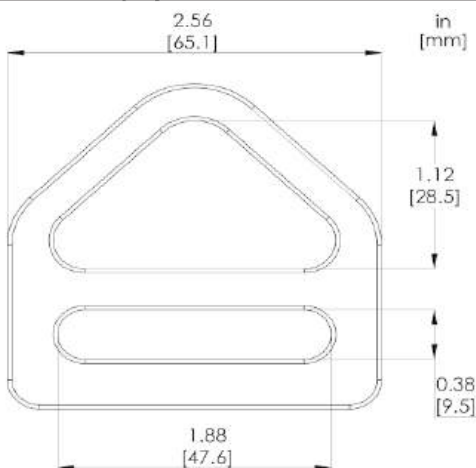

Specifications

- 9029 1 3/4" Tri D-Ring
- Sheet Stamping Steel
- 100% proof loaded to 3,600 lbs (16kN)
- Min tensile strength 5,000 lbs (22.2kN)

Meets Or Exceeds:

- ANSI/ASSP Z359.12-2019
- CSA Z259.12-16

Weight: 3.2oz (91gm)

9029



RINGS

3662



Specifications

- 3662 2 1/2" Double Slot D-Ring
- Drop Forged Steel
- 100% proof loaded to 3,600 lbs (16kN)
- Min tensile strength 5,000 lbs (22.2kN)

Meets Or Exceeds:

- ANSI/ASSP Z359.12-2019
- CSA Z259.12-16

Weight: 6.5oz (183gm)

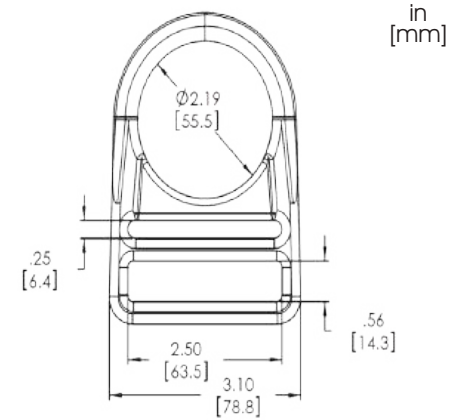

3652



Specifications

- 3652 2 9/16" Contoured Positioning D-Ring
- Drop Forged Steel
- 100% proof loaded to 3,600 lbs (16kN)
- Min tensile strength 5,000 lbs (22.2kN)

Certified To:

- ANSI/ASSP Z359.12-2019
- CSA Z259.12-16

Weight: 7.4oz (208gm)

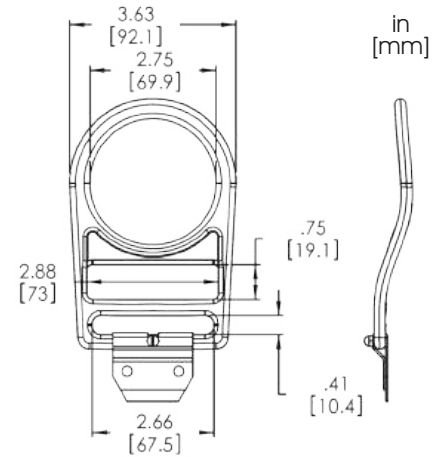

3840



Specifications

- 3840 1 3/4" Single Slot D-Ring
- Drop Forged Steel
- 100% proof loaded to 3,600 lbs (16kN)
- Min tensile strength 5,000 lbs (22.2kN)

Certified To:

- ANSI/ASSP Z359.12-2019
- CSA Z259.12-16

Weight: 2.9oz (83gm)

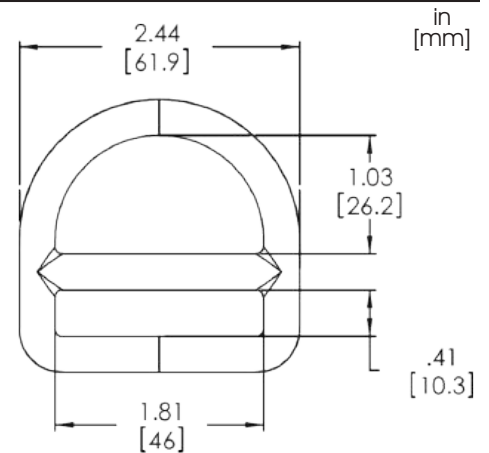

3841



Specifications

- 3841 1 3/4" Single Slot D-Ring Cranked 40 Degree
- Drop Forged Steel
- 100% proof loaded to 3,600 lbs (16kN)
- Min tensile strength 5,000 lbs (22.2kN)

Certified To:

- ANSI/ASSP Z359.12-2019
- CSA Z259.12-16

Weight: 3.2oz (91gm)

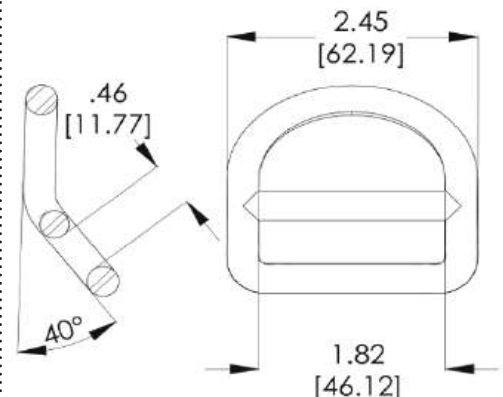

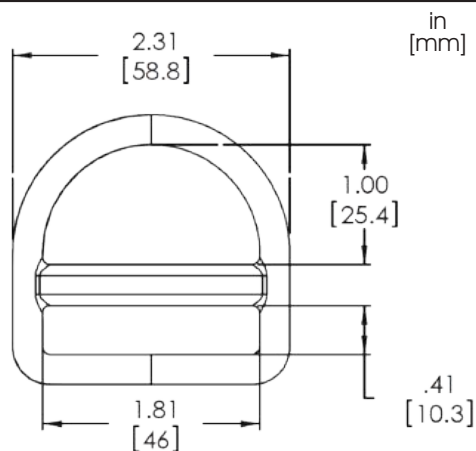

Specifications

- 3830 1 3/4" Single Slot D-Ring
- Drop Forged Steel
- 100% proof loaded to 3,600 lbs (16kN)
- Min tensile strength 5,000 lbs (22.2kN)

Certified To:

- ANSI/ASSP Z359.12-2019
- CSA Z259.12-16

Weight: 2.3oz (64gm)

3830

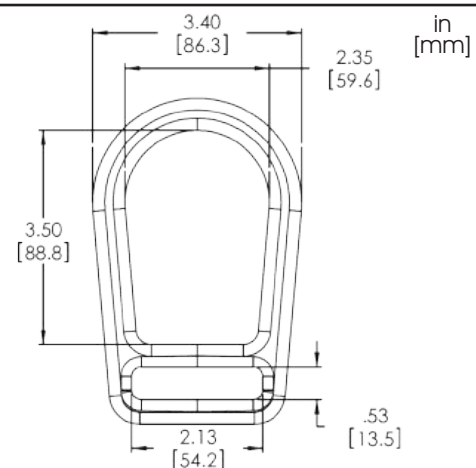

Specifications

- 3850 2 1/8" Single Slot Sling D-Ring
- Drop Forged Steel
- 100% proof loaded to 3,600 lbs (16kN)
- Min tensile strength 16,000 lbs (71kN)
- Designed to allow one 3850 to pass through another 3850 in configuration.

Meets Or Exceeds:

- ANSI/ASSP Z359.12-2019
- CSA Z259.12-16

Weight: 10.7oz (306gm)

3850

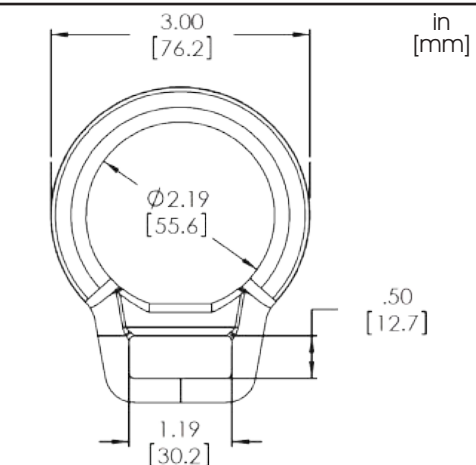

Specifications

- 3200 1 13/16" Single Slot D-Ring
- Drop Forged Steel
- 100% proof loaded to 3,600 lbs (16kN)
- Min tensile strength 5,000 lbs (22.2kN)

Certified To:

- ANSI/ASSP Z359.12-2019
- CSA Z259.12-16

Weight: 3.8oz (107gm)

3200

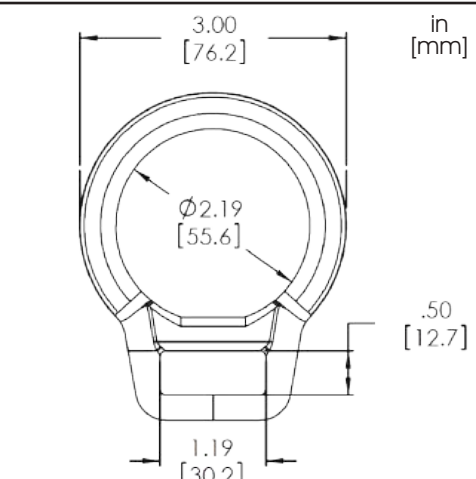

Specifications

- 3220 1 13/16" Single Slot D-Ring
- Drop Forged Steel
- 100% proof loaded to 3,600 lbs (16kN)
- Min tensile strength 5,000 lbs (22.2kN)

Certified To:

- ANSI/ASSP Z359.12-2019
- CSA Z259.12-16

Weight: 3.7oz (104gm)

3220



RINGS

9840



Specifications

- 9840 1 13/16" Single Slot D-Ring
- Sheet Stamping Steel
- 100% proof loaded to 3,600 lbs (16kN)
- Min tensile strength 5,000 lbs (22.2kN)

Certified To:

- ANSI/ASSP Z359.12-2019
- CSA Z259.12-16

Weight: 2.4oz (68gm)

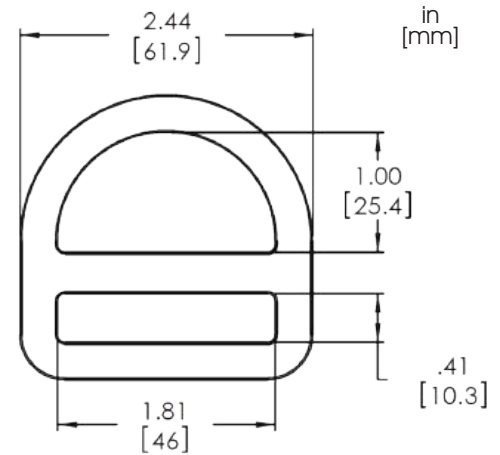

3230



Specifications

- 3230 1-3/4" Pass Through D-Ring
- Drop Forged Steel
- 100% proof loaded to 3,600 lbs (16kN)
- Min tensile strength 5,000 lbs (22.2kN)

Certified To:

- ANSI/ASSP Z359.12-2019
- CSA Z259.12-16

Weight: 4.3oz (122gm)

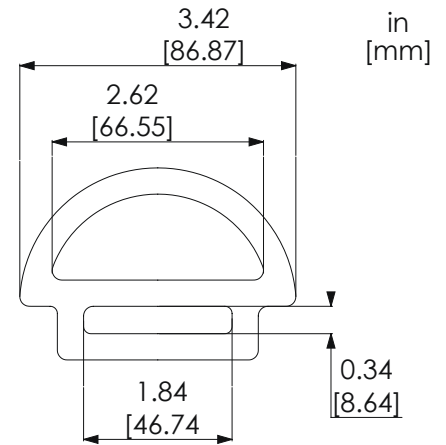

3063



Specifications

- 3063 2" D-Ring
- Drop Forged Steel
- 100% proof loaded to 3,600 lbs (16kN)
- Min tensile strength 5,000 lbs (22.2kN)

Certified To:

- ANSI/ASSP Z359.12-2019
- CSA Z259.12-16

Weight: 4.8oz (135gm)

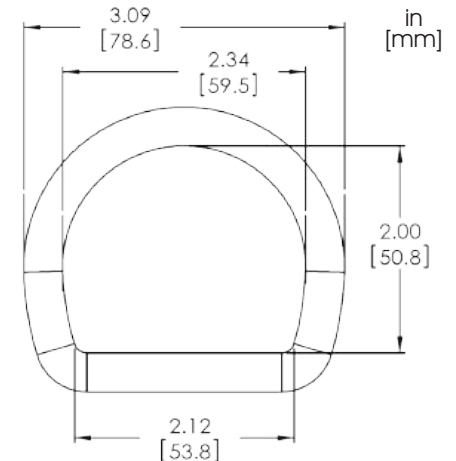

3064



Specifications

- 3064 3 1/8" D-Ring
- Drop Forged Steel
- 100% proof loaded to 3,600 lbs (16kN)
- Min tensile strength 5,000 lbs (22.2kN)

Certified To:

- ANSI/ASSP Z359.12-2019
- CSA Z259.12-16

Weight: 5.5oz (155gm)

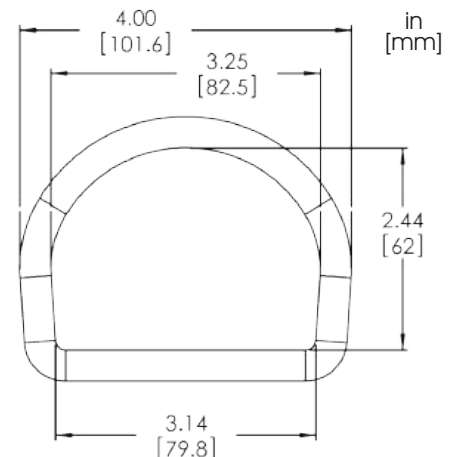

RINGS

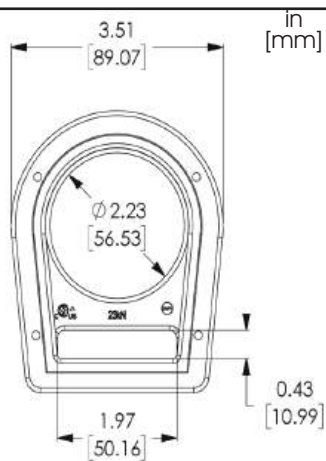

Specifications

- 9500 2 3/64" Dielectric Overmolded D-Ring
- Sheet Stamping Steel
- 100% proof loaded to 3,600 lbs (16kN)
- Min tensile strength 5,000 lbs (22.2kN)

Certified To:

- ANSI/ASSP Z359.12-2019
- CSA Z259.12-16

Weight: 4.9oz (137gm)

9500



O-RING COMPATIBILITY



7500



7500
7600
7700



7600



7700



7800

Part	7500	7600
7600	•	
7700	•	•
7800	•	

For details and availability please contact Customer Service.

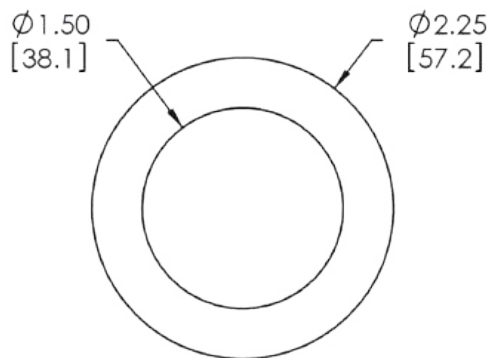

in
[mm]

Specifications

- 7500 1 1/2" O-Ring
- Drop Forged Steel
- 100% proof loaded to 3,600 lbs (16kN)
- Min tensile strength 5,000 lbs (22.2kN)

Certified To:

- ANSI/ASSP Z359.12-2019
- CSA Z259.12-16

Weight: 2.9oz (82gm)

7500

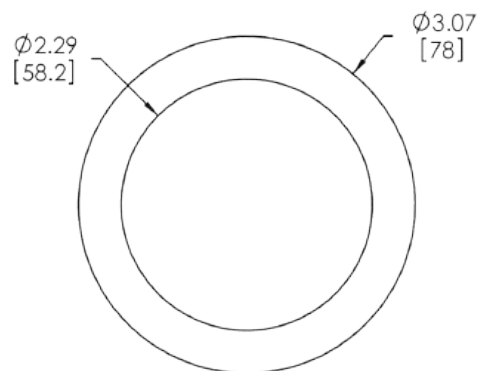

in
[mm]

Specifications

- 7600 2 5/16" O-Ring
- Drop Forged Steel
- 100% proof loaded to 3,600 lbs (16kN)
- Min tensile strength 5,000 lbs (22.2kN)

Certified To:

- ANSI/ASSP Z359.12-2019
- CSA Z259.12-16

Weight: 4.1oz (116gm)

7600

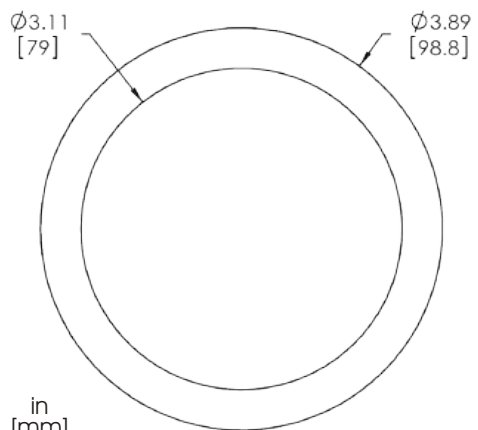

in
[mm]

Specifications

- 7700 3 1/8" O-Ring
- Drop Forged Steel
- 100% proof loaded to 3,600 lbs (16kN)
- Min tensile strength 5,000 lbs (22.2kN)

Certified To:

- ANSI/ASSP Z359.12-2019
- CSA Z259.12-16

Weight: 5.5oz (155gm)

7700

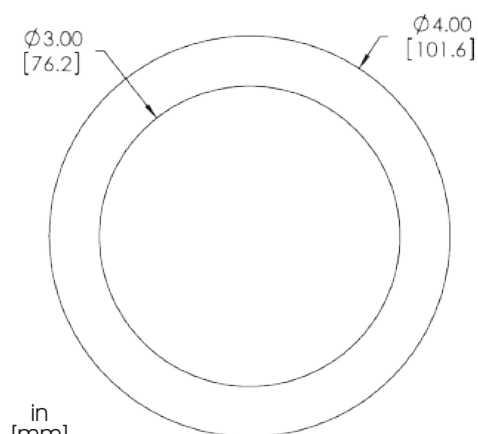

in
[mm]

Specifications

- 7800 3" O-Ring
- Drop Forged Steel
- 100% proof loaded to 3,600 lbs (16kN)
- Min tensile strength 10,000 lbs (45kN)

Certified To:

- ANSI/ASSP Z359.12-2019
- CSA Z259.12-16

Weight: 9.5oz (266gm)

7800



RINGS

A750



Specifications

- A750 28mm O-Ring
- Drop Forged Aluminium
- 100% proof loaded to 3,600 lbs (16kN)
- Min tensile strength 5,620 lbs (25kN)

Certified To:

- ANSI/ASSP Z359.12-2019
- CSA Z259.12-16

Weight: 1.2oz (34gm)

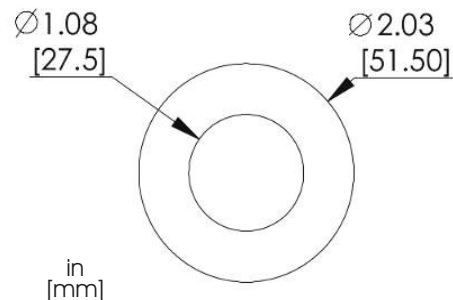

A760



Specifications

- A760 45mm O-Ring
- Drop Forged Aluminium
- 100% proof loaded to 3,600 lbs (16kN)
- Min tensile strength 5,620 lbs (25kN)

Certified To:

- ANSI/ASSP Z359.12-2019
- CSA Z259.12-16

Weight: 1.9oz (54gm)

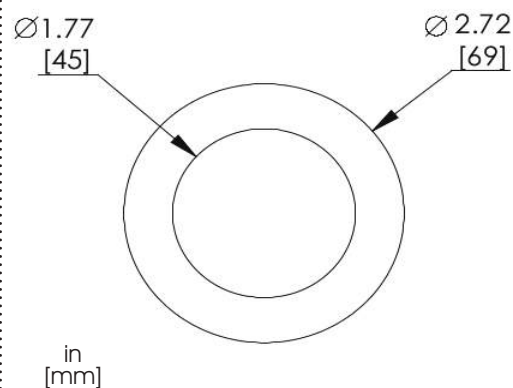

QUICK CONNECT BUCKLE FAMILIES



9074



9076



9053



9055



9154



9072



9052



9058



1062



9260



9290

Dielectric Overmolded Frames



9078



9156

QUICK CONNECT BUCKLE RECOMMENDED COMPATIBILITY

Part	9053	9055	9154	9052	9058	9260	9290	9156
9074	•	•	•	•				
9076	•	•	•					
9072				•	•			
1062						•	•	
9078								•

NOTE: BUCKLES CAN BE PROOF LOADED UPON REQUEST.

BUCKLES

9111



Specifications

- 9111 Adjuster
 - Sheet Stamping Steel
 - Min tensile strength 4,000 lbs (17.8kN)
- Meets Or Exceeds:
- CSA Z259.12-16

in
[mm]

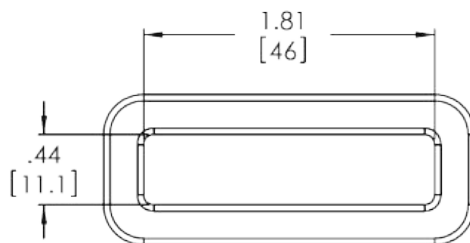

Weight: 1.2oz (34gm)

9074



Specifications

- 9074 Quick Connect Buckle
 - Sheet Stamping Steel
 - Min tensile strength 4,000 lbs (17.8kN)
- Certified To:
- ANSI/ASSP Z359.12-2019
 - CSA Z259.12-16

in
[mm]

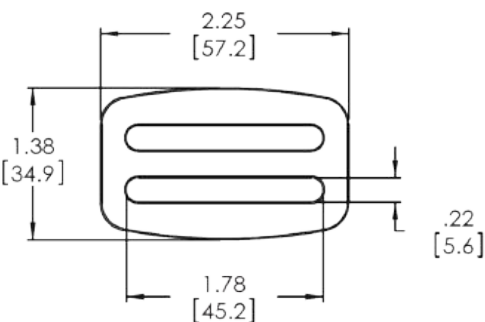

Weight: 1.2oz (39gm)

9076



Specifications

- 9076 Quick Connect Buckle
 - Sheet Stamping Steel
 - Min tensile strength 4,000 lbs (17.8kN)
- Meets Or Exceeds:
- ANSI/ASSP Z359.12-2019
 - CSA Z259.12-16

in
[mm]

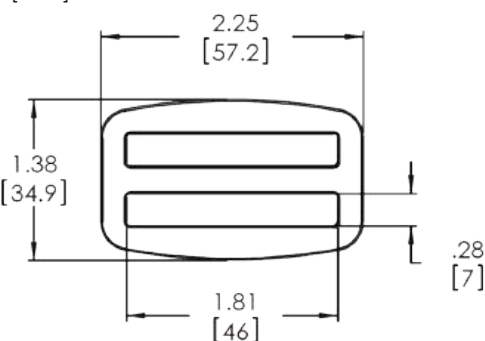

Weight: 1.1oz (31gm)

9053



Specifications

- 9053 Quick Connect Buckle
 - Sheet Stamping Steel
 - Min tensile strength 4,000 lbs (17.8kN)
- Certified To:
- ANSI/ASSP Z359.12-2019
 - CSA Z259.12-16

in
[mm]

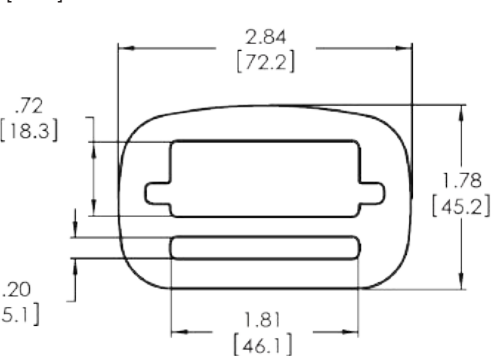

Weight: 1.8oz (51gm)

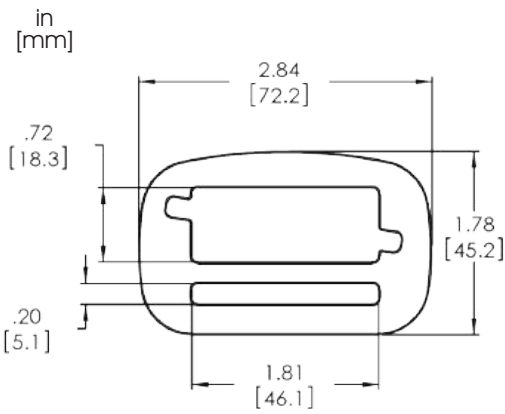

Specifications

- 9055 Quick Connect Buckle
 - Sheet Stamping Steel
 - Min tensile strength 4,000 lbs (17.8kN)
- Certified To:
- ANSI/ASSP Z359.12-2019
 - CSA Z259.12-16

Weight: 1.8oz (51gm)

9055

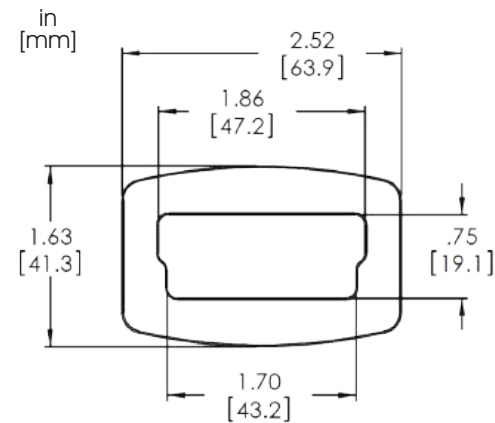

Specifications

- 9154 Quick Connect Buckle
 - Sheet Stamping Steel
 - Min tensile strength 4,000 lbs (17.8kN)
- Certified To:
- ANSI/ASSP Z359.12-2019
 - CSA Z259.12-16

Weight: 1.4oz (39gm)

9154

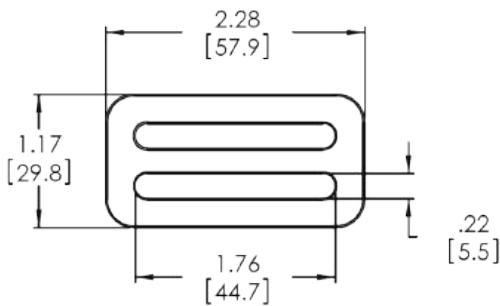

Specifications

- 9072 Quick Connect Buckle
 - Sheet Stamping Steel
 - Min tensile strength 4,000 lbs (17.8kN)
- Certified To:
- ANSI/ASSP Z359.12-2019
 - CSA Z259.12-16

Weight: 1.1oz (31gm)

9072

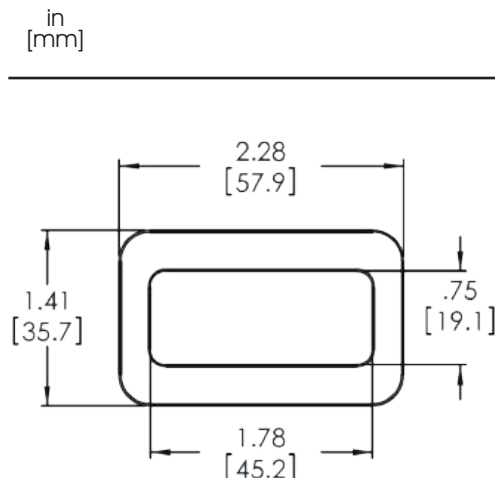

Specifications

- 9052 Quick Connect Buckle
 - Sheet Stamping Steel
 - Min tensile strength 4,000 lbs (17.8kN)
- Certified To:
- ANSI/ASSP Z359.12-2019
 - CSA Z259.12-16

Weight: 1.0oz (28gm)

9052

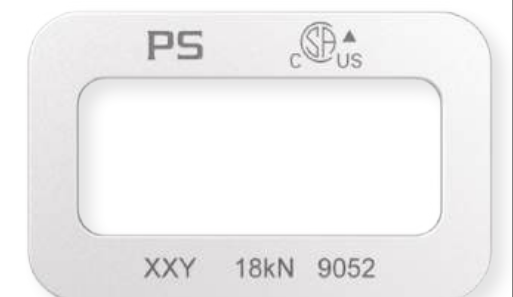

BUCKLES

9058



Specifications

- 9058 Quick Connect Buckle
 - Sheet Stamping Steel
 - Min tensile strength 4,000 lbs (17.8kN)
- Certified To:
- ANSI/ASSP Z359.12-2019
 - CSA Z259.12-16

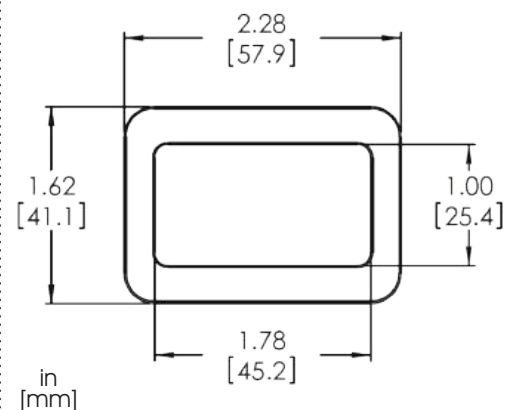

Weight: 1.0oz (28gm)

9078



Specifications

- 9078 Dielectric Overmolded 3-Bar
 - Sheet Stamping Steel
 - Min tensile strength 4,000 lbs (17.8kN)
- Certified To:
- ANSI/ASSP Z359.12-2019
 - CSA Z259.12-16

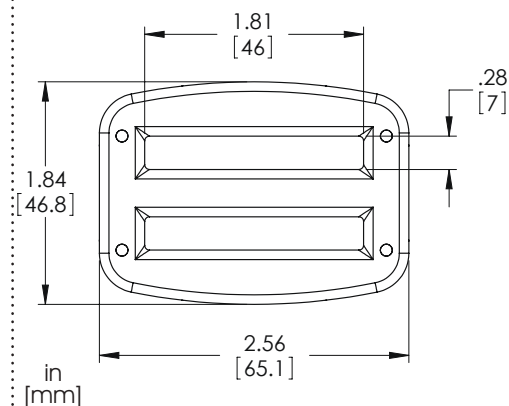

Weight: 1.5oz (43gm)

9156



Specifications

- 9156 Dielectric Overmolded Frame
 - Sheet Stamping Steel
 - Min tensile strength 4,000 lbs (17.8kN)
- Certified To:
- ANSI/ASSP Z359.12-2019
 - CSA Z259.12-16

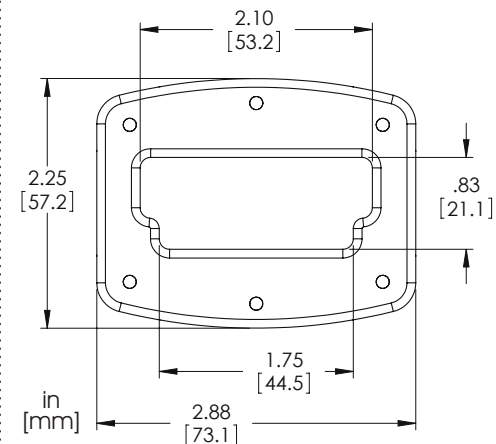

Weight: 2.2oz (63gm)

1222



Specifications

- 1222 Sliding Bar Friction Buckle
 - Drop Forged Steel
 - Min tensile strength 4,000 lbs (17.8kN)
- Certified To:
- ANSI/ASSP Z359.12-2019
 - CSA Z259.12-16

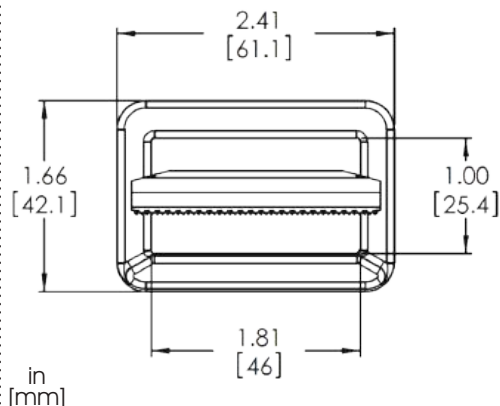

Weight: 3.0oz (84gm)

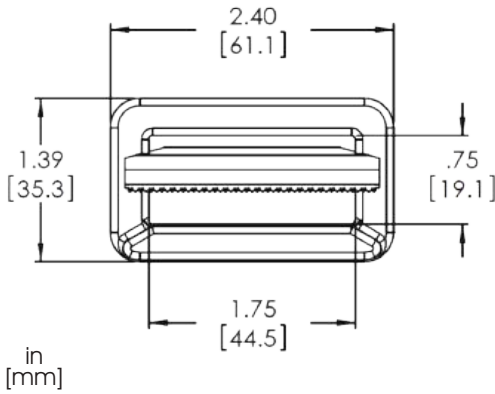

Specifications

- 1223 Sliding Bar Friction Buckle
 - Drop Forged Steel
 - Min tensile strength 4,000 lbs (17.8kN)
- Meets Or Exceeds:
- ANSI/ASSP Z359.12-2019
 - CSA Z259.12-16

Weight: 2.9.0oz (81gm)

1223

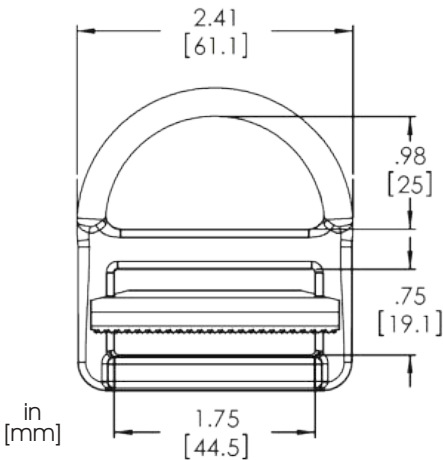
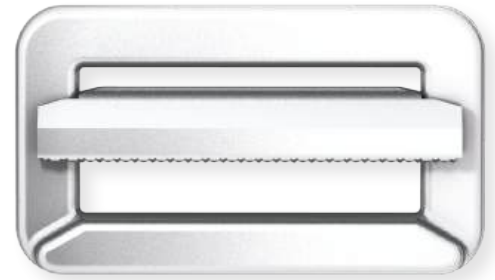

Specifications

- 1226 Sliding Bar Friction Buckle
 - Drop Forged Steel
 - Min tensile strength 5,000 lbs (22.2kN)
- Certified To:
- ANSI/ASSP Z359.12-2019
 - CSA Z259.12-16

Weight: 3.0oz (84gm)

1226

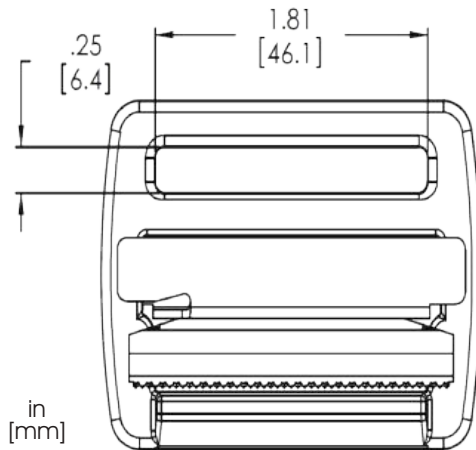

Specifications

- 1224 Sliding Bar Friction Buckle Spring Loaded
 - Drop Forged Steel
 - Min tensile strength 4,000 lbs (17.8kN)
- Certified To:
- ANSI/ASSP Z359.12-2019
 - CSA Z259.12-16

Weight: 3.8oz (107gm)

1224

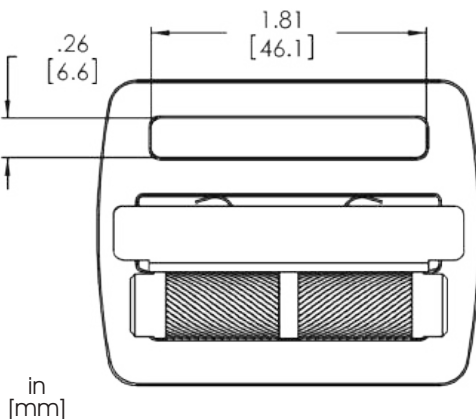

Specifications

- 9224 Sliding Bar Adjuster Spring Loaded
 - Sheet Stamping Steel
 - Min tensile strength 4,000 lbs (17.8kN)
- Certified To:
- ANSI/ASSP Z359.12-2019
 - CSA Z259.12-16

Weight: 3.4oz (96gm)

9224



BUCKLES

9225



Specifications

- 9225 Sliding Bar Adjuster
- Sheet Stamping Steel
- Min tensile strength 4,000 lbs (17.8kN)

Certified To:

- ANSI/ASSP Z359.12-2019
- CSA Z259.12-16

Weight: 2.7oz (76gm)

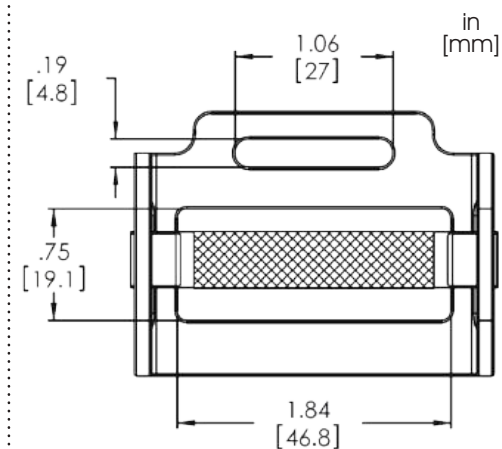

9225-2



Specifications

- 9225-2 Sliding Bar Adjuster With Round Spring
- Sheet Stamping Steel
- Min tensile strength 4,000 lbs (17.8kN)

Certified To:

- ANSI/ASSP Z359.12-2019
- CSA Z259.12-16

Weight: 2.7oz (76gm)

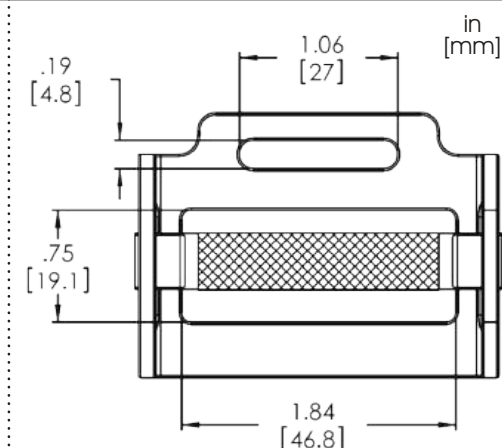

9233/0516



Specifications

- 9233 Buckle with 0516 Adjuster Bar
- Sheet Stamping Steel
- Min tensile strength 4,000 lbs (17.8kN)
- 0516 Sold Separately

Certified To:

- ANSI/ASSP Z359.12-2019
- CSA Z259.12-16

Weight: 1.8oz (51gm)

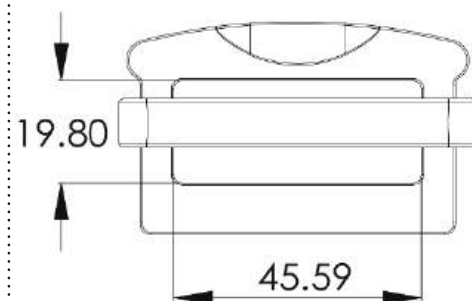

9232/0516



Specifications

- 9232 Buckle with 0516 Adjuster Bar
- Sheet Stamping Steel
- Min tensile strength 4,000 lbs (17.8kN)
- 0516 Sold Separately

Certified To:

- ANSI/ASSP Z359.12-2019
- CSA Z259.12-16

Weight: 1.8oz (51gm)

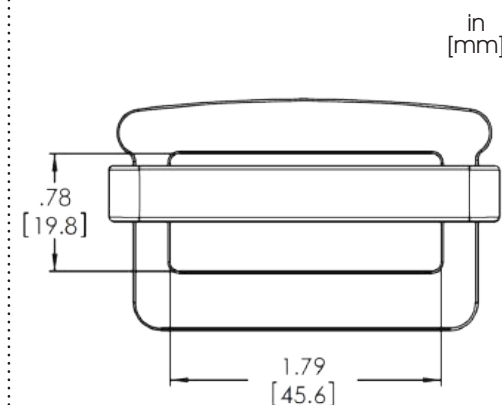

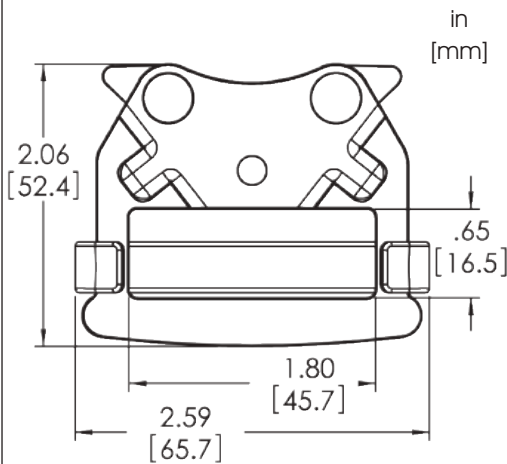

Specifications

- 9260 Quick connect buckle
- Sheet Stamping Steel
- Min tensile strength 4,000 lbs (17.8kN)
- Available with E-Coat finish
- Compatible only with 1062

Certified to:

- ANSI/ASSP Z359.12-2019
- CSA Z259.12-16

Weight: 3.38oz (95.9gm)

9260

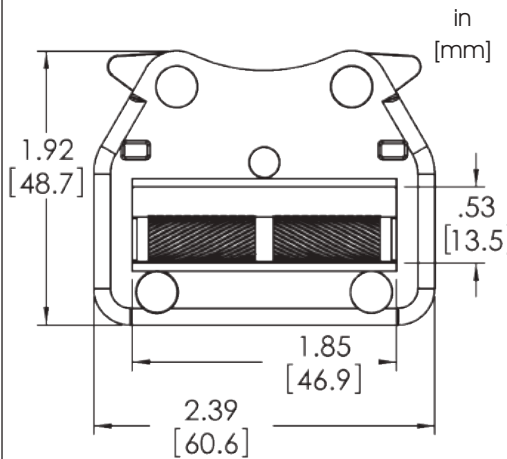
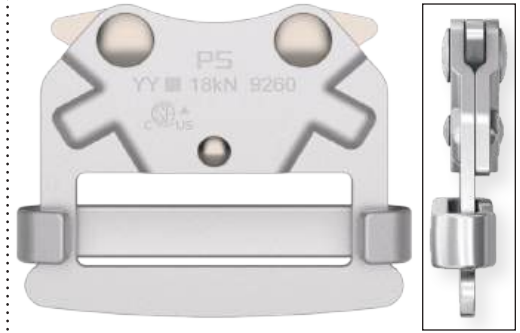

Specifications

- 9290 Quick connect buckle
- Sheet Stamping Steel
- Min tensile strength 4,000 lbs (17.8kN)
- Available with E-Coat finish
- Compatible only with 1062

Certified to:

- ANSI/ASSP Z359.12-2019
- CSA Z259.12-16

Weight: 3.04oz (86.2gm)

9290

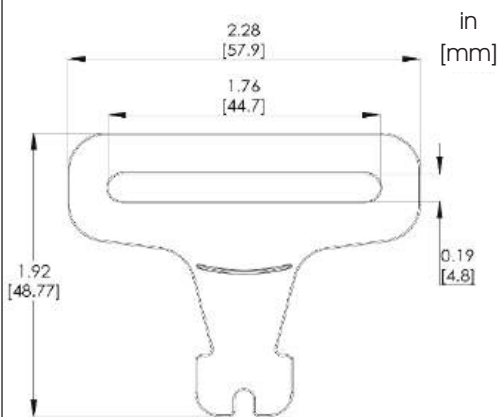

Specifications

- 1062 single slot attachment
- Sheet Stamping Steel
- Min tensile strength 4,000 lbs (17.8kN)
- Sold with 9260 or 9290

Certified to:

- ANSI/ASSP Z359.12-2019
- CSA Z259.12-16

Weight: 1.05oz (29.8gm)

1062

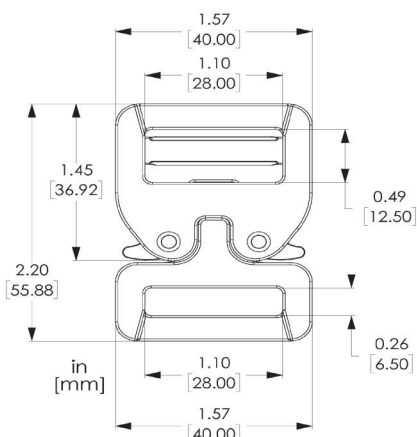

Specifications

- 9242 Quick connect buckle
 - Drop Forged Anodized Aluminum
 - Min tensile 3,372 lbs (15 kN)
- Certification Pending to
- ANSI/ASSP Z259.12-2019
 - CSA Z259.12.-16

Weight: 1.9oz (54g)

9242



BUCKLES

9245



Specifications

- 9245 Quick connect buckle
 - Anodized Extruded Aluminum
 - Min tensile strength 4,000 lbs (17.8kN)
- Certified to:
- ANSI/ASSP Z359.12-2019
 - CSA Z259.12-16



Weight: 3.56oz (101gm)

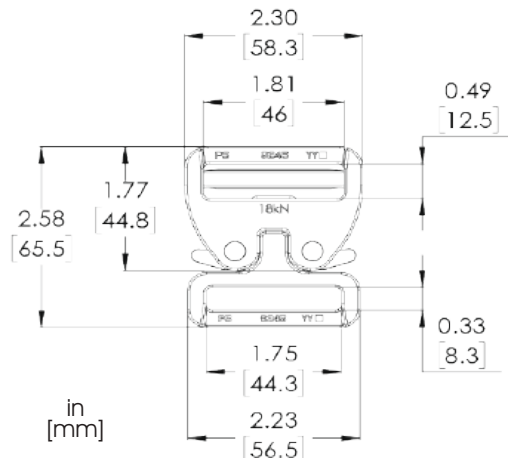

9254



Specifications

- 9254 Dielectric Adjuster
 - Sheet Stamping Steel Over-molded
- Certification Pending to
- ANSI/ASSP Z259.12-2019
 - CSA Z259.12.-16



Weight: 3.08oz (107g)

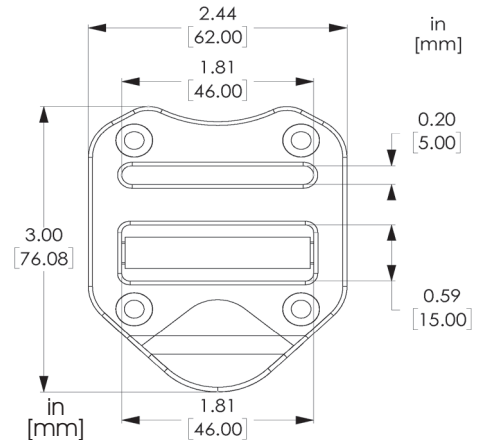

9256



Specifications

- 9256/1078 Dielectric Quick Connect Buckle Assembly
 - Sheet Stamping Steel -Over-molded
 - Min tensile strength 4,000 lbs (17.8 kN)
 - Compatible only with 1078
- Certification Pending To:
- ANSI/ASSP Z359.12-2019
 - CSA Z259.12-16

Weight: 4.9oz (139gm)

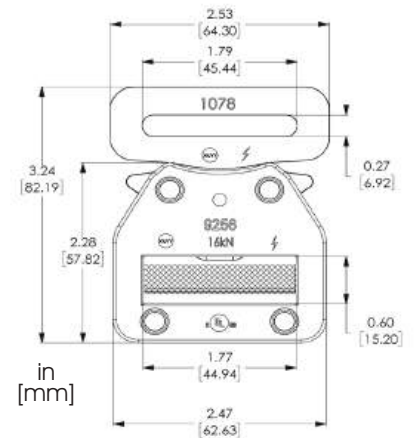

1220



Specifications

- 1220 Adapter Buckle
 - Drop Forged Steel
 - Min tensile strength 4,000 lbs (17.8kN)
- Certified To:
- ANSI/ASSP Z359.12-2019
 - CSA Z259.12-16

Weight: 4.0oz (113gm)

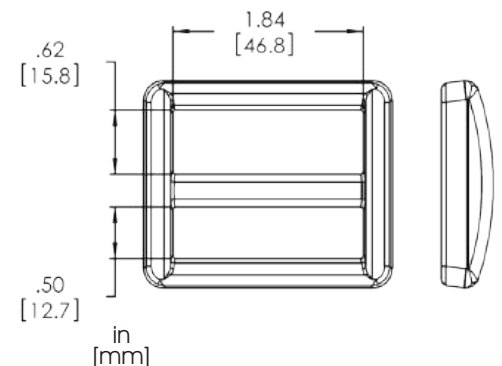

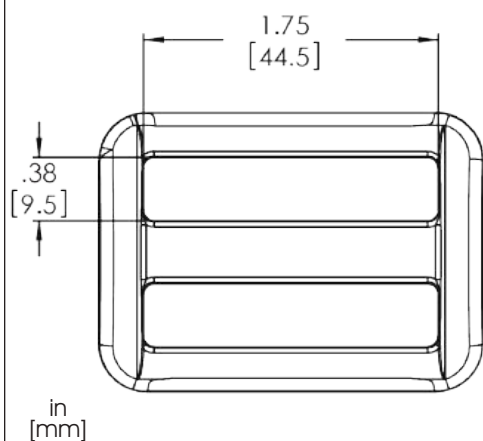

Specifications

- 1024 Adapter Buckle
 - Drop Forged Steel
 - Min tensile strength 4,000 lbs (17.8kN)
- Certified To:
- CSA Z259.12-16
 - ANSI/ASSP Z359.12-2019

Weight: 2.2oz (62gm)

1024

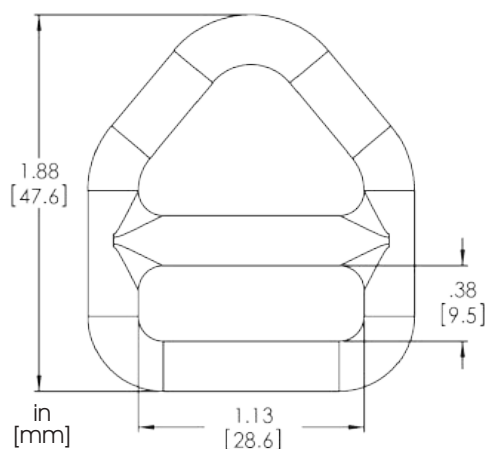

Specifications

- 1028 Tri Adjuster
 - Drop Forged Steel
 - Min tensile strength 4,000 lbs (17.8kN)
- Meets Or Exceeds:
- ANSI/ASSP Z359.12-2019
 - CSA Z259.12-16

Weight: 1.6oz (45gm)

1028

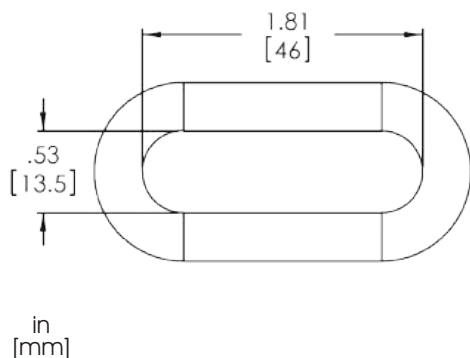
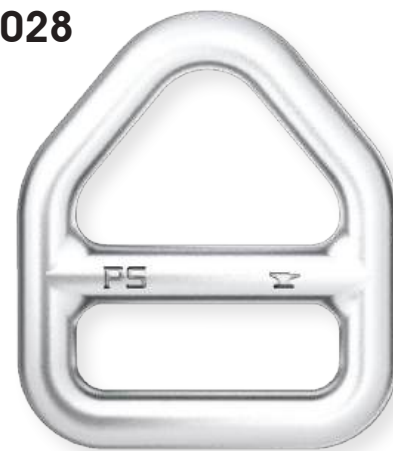

Specifications

- 9031 Oval Adjuster
 - Drop Forged Steel
 - Min tensile strength 5,000 lbs (22.2kN)
- Certified To:
- ANSI/ASSP Z359.12-2019
 - CSA Z259.12-16

Weight: 1.8oz (50gm)

9031

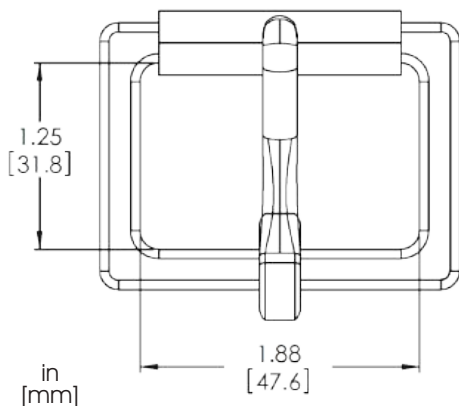

Specifications

- 1010 Tongue Buckle
 - Sheet Stamping Steel
 - Min tensile strength 4,000 lbs (17.8kN)
- Certified To:
- ANSI/ASSP Z359.12-2019
 - CSA Z259.12-16

Weight: 3.0oz (84gm)

1010



BUCKLES

2022

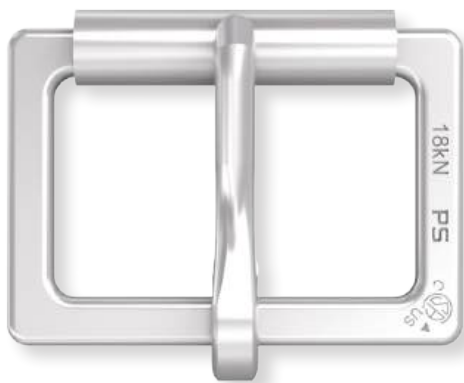

Specifications

- 2022 Tongue Buckle
- Sheet Stamping Steel
- Min tensile strength 4,000 lbs (17.8kN)

Certified To:

- ANSI/ASSP Z359.12-2019
- CSA Z259.12-16

Weight: 3.5oz (98gm)

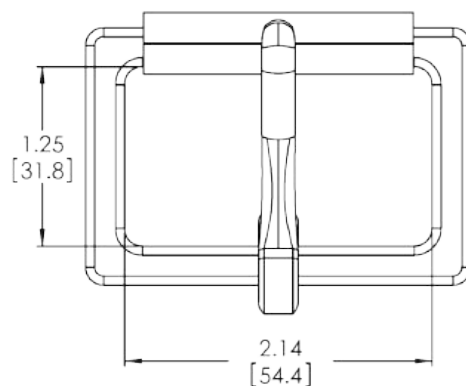

1022



Specifications

- 1022 Adjuster
- Drop Forged Steel
- Min tensile strength 5,000 lbs (22.2kN)

Certified To:

- ANSI/ASSP Z359.12-2019
- CSA Z259.12-16

Weight: 1.8oz (51gm)

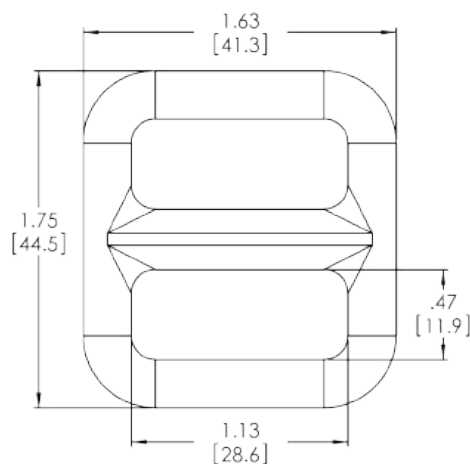

COMPATIBLE QUICK
CONNECT BUCKLE

Part	9156
9078	•

9256



Page 48

9078



Page 44

9156





PARACHUTE/RESCUE

$\varnothing 1.74$
 (44.19)

$\varnothing 2.29$
 (58.16)

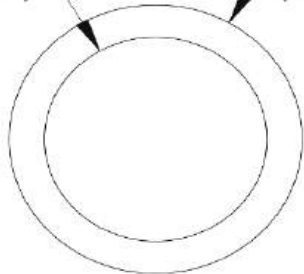

in
[mm]

Specifications

- 7550 1 3/4" O-Ring
- Drop Forged Steel
- 100% Proof Loaded to 3,600 lbs (16kN)
- Min tensile strength 5,000 lbs (22.2kN)

Meets or Exceeds:

- ANSI/ASSP Z359.12-2019
- CSA Z259.12-16

Weight: 1.5oz (43gm)

7550

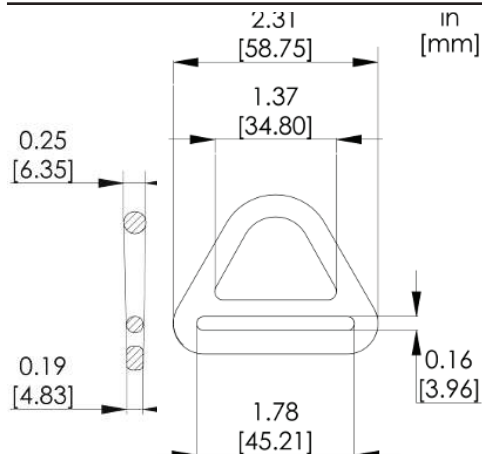

Specifications

- 1034 Tri D-Ring (PS22020-1)
- Drop Forged Steel
- 100% proof loaded to 3,600 lbs (16kN)
- Min tensile strength 5,000 lbs (22.2kN)

Certified To:

- ANSI/ASSP Z359.12-2019
- CSA Z259.12-16

Weight: 1.4oz (41gm)

1034

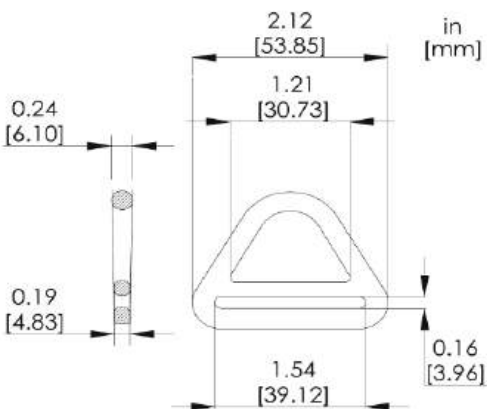

Specifications

- 1038 Tri D-Ring
- Drop Forged Steel
- 100% proof loaded to 3,600 lbs (16kN)
- Min tensile strength 5,000 lbs (22.2kN)

Certified To:

- ANSI/ASSP Z359.12-2019
- CSA Z259.12-16

Weight: 1.5oz (42.5gm)

1038

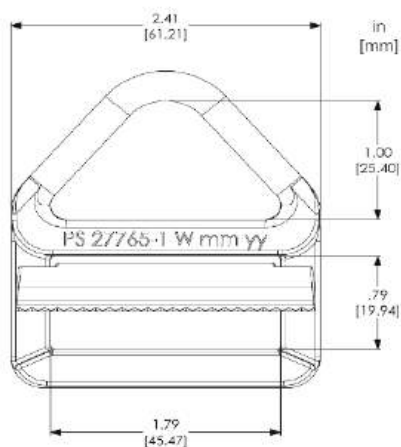

Specifications

- 1227 Triangular Adjuster (PS27765)
- Drop Forged Steel
- Min tensile strength 4,000 lbs (17.8kN)
- Available in Clear and Yellow

Weight: 4.42oz (125.3gm)

1227



PS22044



Specifications

- PS22044 Snap Hook
- Drop Forged Steel
- 100% proof loaded to 2,500 lbs (11.1kN)
- Min tensile strength 5,000 lbs (22.2kN)

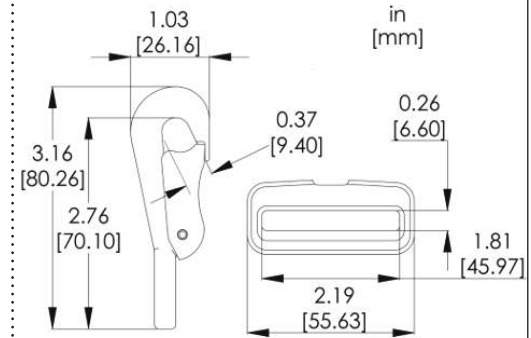

Weight: 4.0oz (112gm)

5064



Specifications

- 5064 5/16" Strap Snap Hook
- Drop Forged Steel
- 100% proof loaded to 3,600 lbs (16kN)
- Min tensile strength 5,000 lbs (22.2kN)

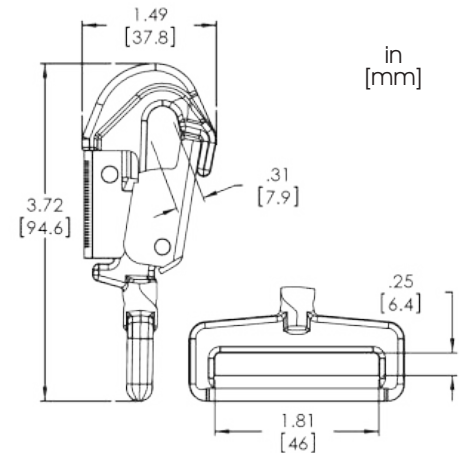

Weight: 4.6oz (129gm)

5066



Specifications

- 5066 Snap Hook (PS22042)
- Drop Forged Steel
- 100% proof loaded to 3,600 lbs (16kN)
- Min tensile strength 5,000 lbs (22.2kN)

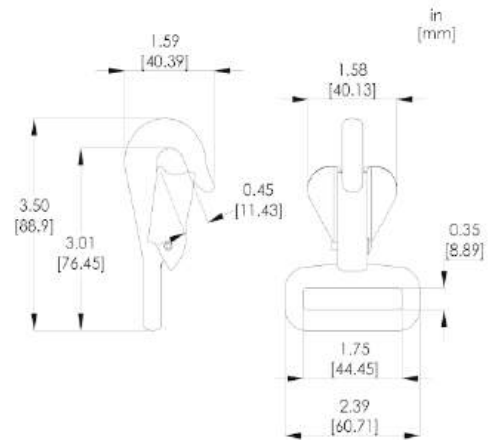

Weight: 5.96oz (169gm)

MISCELLANEOUS

T1532-05-P-00-02-1 (Lanyard With A213 Carabiner)



A213 Specifications: (Next Page)



Meets or exceeds when Tested to 15lb Tool Limit per ANSI/SEA 121-2018

PS
P/N: T1532
Date:

Load Limit: 6.8 Kg/15 Lbs
Tether Length Retracted: 86cm/32in
Tether Length Extended: 132cm/50in
Meet or Exceeds ANSI-ISEA-121

SEWN IN LABEL

MISCELLANEOUS

A213



Specifications

- A213 Tool Tether Carabiner
- Cold Formed Aluminium
- For Locksafe (Triple Action) A217

Weight: 1.1oz (31.2gm)

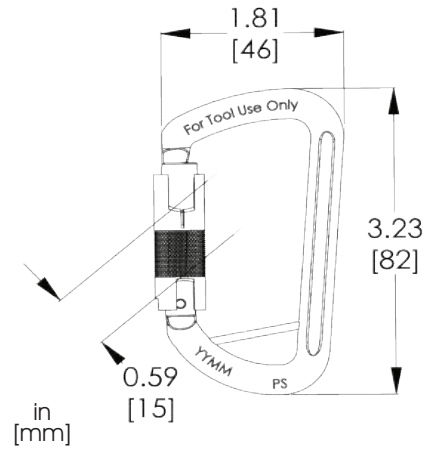

T1532



Specifications

- T1532 Tool Tether with A213 Carabiner
- Load Limit: 6.8 Kg/15 Lbs
- Tether Length Retracted: 86cm/32in
- Tether Length Extended: 132cm/50in
- Meets or Exceeds When Tested To 15lb Tool:
- ANSI-ISEA-121

Weight: 2.2oz (62.4gm)

- Tether Length Retracted: 86cm/32in
- Tether Length Extended: 132cm/50in

5045



Specifications

- 5045 3" Figure Eight Descender
- Drop Forged Steel
- Min tensile strength 15,000 lbs (66.6kN)

Weight: 26oz (731gm)

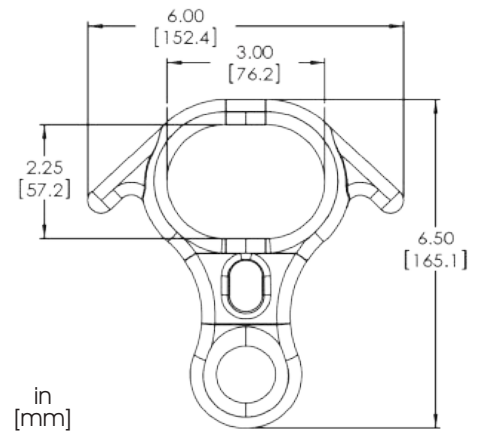

4550



Specifications

- 4550 1 25/32" Swivel Eye
- Drop Forged Steel
- Min tensile strength 5,000 lbs (22.2kN)

Weight: 2.4oz (68gm)

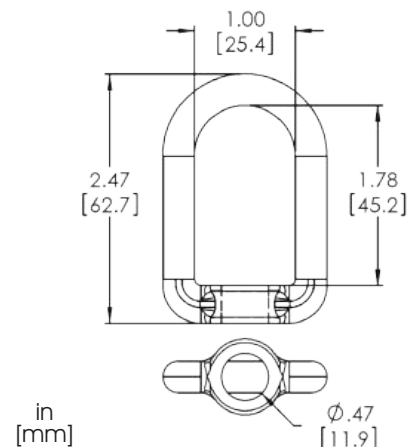

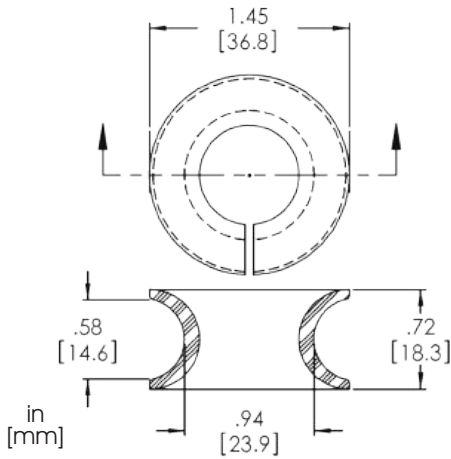

Specifications

- MT01 1/2" Thimble
- High Density Plastic

MT01

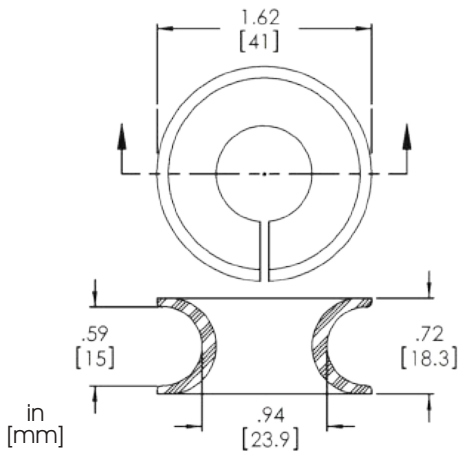

Specifications

- MT02 5/8" Thimble
- High Density Plastic

MT02

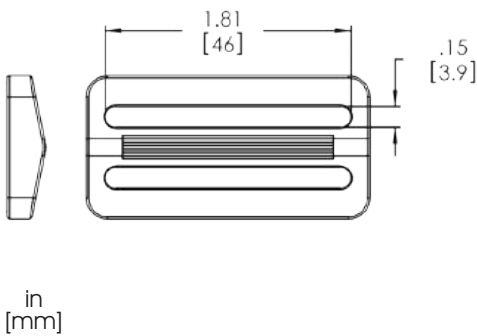

Specifications

- MBA03 3 Bar Adjuster
- Nylon 6

MBA03

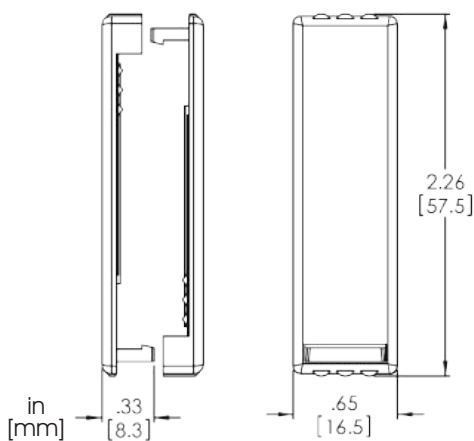

Specifications

- MBK02 2 1/4" Belt Keeper
- Nylon 6

MBK02



MISCELLANEOUS

MBK03



Specifications

- MBK03 2" 1-Piece Belt Keeper
- Nylon 6

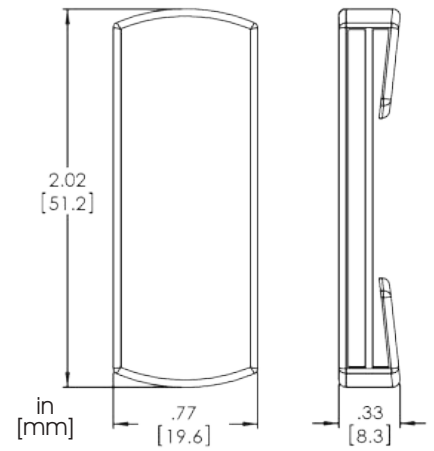

MBP01



Specifications

- MBP01 4 9/16" Back Pad
- TPE4185N03

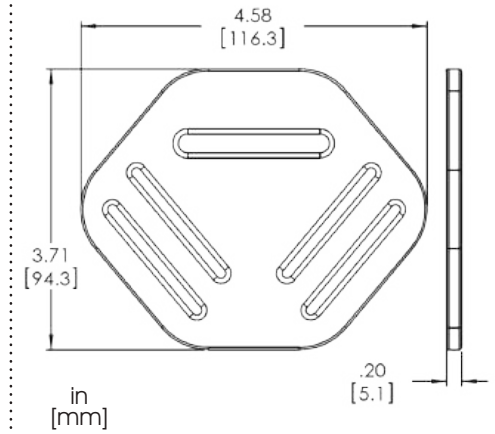

MBP02



Specifications

- MBP02 4 9/16" Back Pad
- TPE4185N03

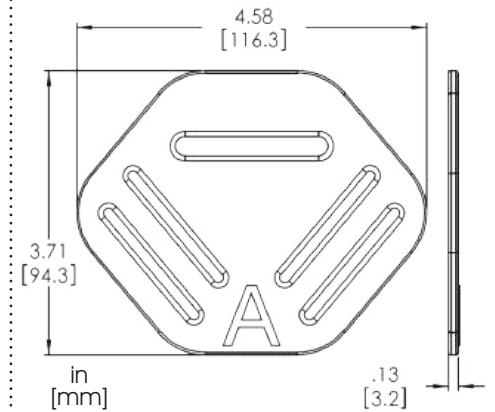

Why Forge? A cross section of a number of forged connectors shows that the etched grain structure is consistent with the part shape; the connector will have improved resistance to multidirectional vector forces. The shape is enhanced by grain structure.



ANSI/ASSP Z359.12-2019 REQUIREMENTS FOR SNAP HOOKS AND CARABINERS

The American National Standard (ANSI/ASSE Z359.1-2007) became effective November 24, 2007. The new standard increased the minimum gate face and side load requirements for connectors to meet or exceed 3,600lb (16kN).

Connectors with non-integral eyes are also required to meet a minor axis gate strength of 3,600 lbs (16kN). The connector gate must be marked with the load rating; the body of the connector must be marked with a major axis load rating. Non-integral connectors are to be clearly marked with ANSI Z359.1.

This standard changed to ANSI/ASSP Z359.12-2019 effective July 6, 2020 incorporating a dynamic drop test requirement. With the New CSA standard Z259.12-11 the Canadian and US standards are harmonized with respect to the requirements for connectors.

Destructive Testing: Testing Configuration

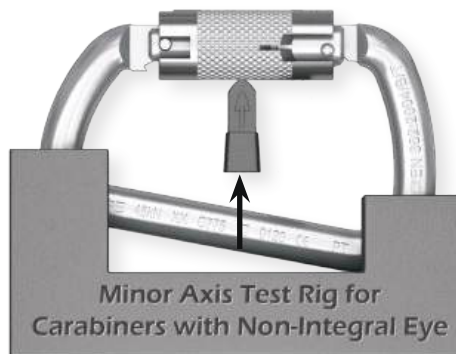
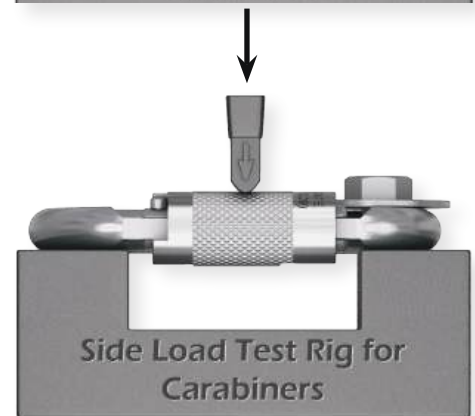
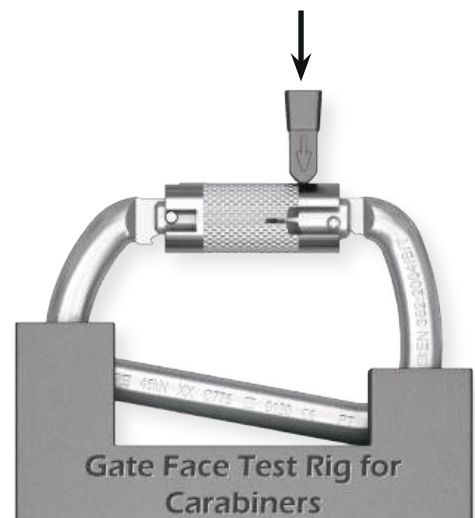
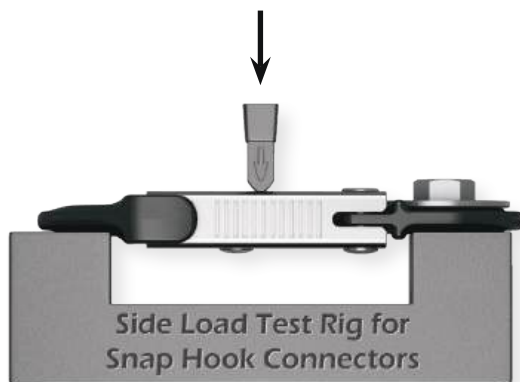
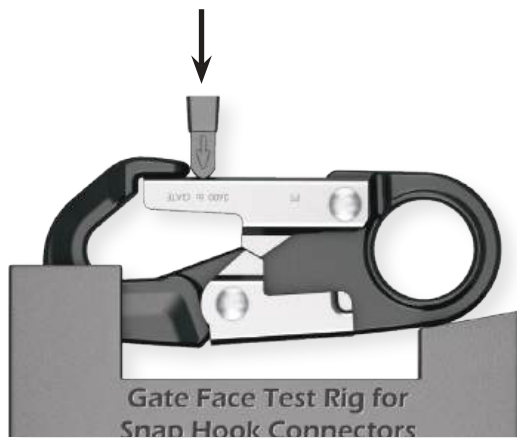

MINIMUM REQUIREMENTS AS OUTLINED FOR HOOKS AND CARABINERS PER STANDARD

Standard	CSA Z259.12- 01	CSA Z259.12- 11	CSA Z259.12- 16	ANSI Z359.1- 1999	ANSI/ASSE Z359.12- 2009	ANSI/ASSP Z359.12- 19	EN 362:2004	NFPA 2500 (1983), 2022ED
Major Axis	5000 lbs (22.2kN)	5000 lbs (22.2kN)	5000 lbs (22.2kN)	5000 lbs (22.2kN)	5000 lbs (22.2kN)	5000 lbs (22.2kN)	4500 lbs (20 kN)	***
Gate Face	220 lbs (1kN)	3600 lbs (16kN)	3600 lbs (16kN)	220 lbs (1kN)	3600 lbs (16kN)	3600 lbs (16kN)	220 lbs (1kN)	N/A
Side Load	350 lbs (1.55kN)	3600 lbs (16kN)	3600 lbs (16kN)	350 lbs (1.55kN)	3600 lbs (16kN)	3600 lbs (16kN)	350 lbs (1.55kN)	N/A
Minor Axis	N/A	3600lbs (16kN)*	3600 lbs (16kN)*	N/A	3600 lbs (16kN) *	3600 lbs (16kN) *	**	***
Transverse	N/A	N/A	3600 lbs (16kN)****	N/A	N/A	3600 lbs (16kN) ****	N/A	N/A

* New Standards require Minor Axis Loading for connectors with non-integral eyes.

** EN: Basic Connector 1575 lbs (7kN); Multi Use Connector 3378 lbs (15kN)

*** NFPA: Light Use... Major Axis gate closed 6069 lbs (23kN); Major Axis gate open 1574 lbs (7kN); Minor Axis 1574 lbs (7kN)
General Use... Major Axis gate closed 8922 lbs (39.7kN); Major Axis gate open 2473 lbs (11kN); Minor Axis 2473 lbs (11kN)

**** New standard require Transverse Loading for connectors with opening one inch or larger

TRANSVERSE BODY LOADING TEST FIXTURE (STATIC)

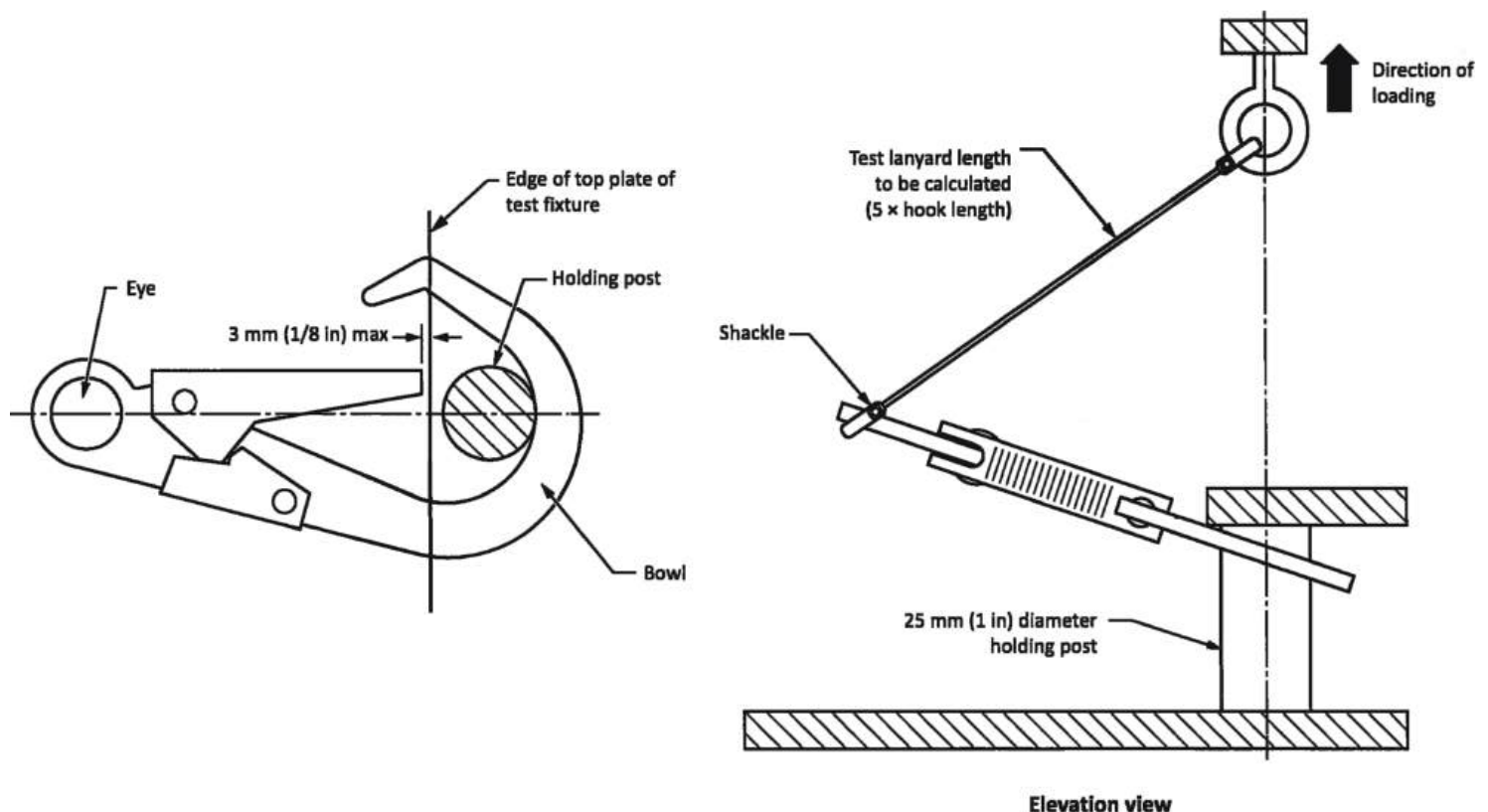

WARNINGS

WARNINGS - CONNECTING COMPONENTS



PENSAFE Inc. is constantly seeking new ways to improve the specifications, design and production of its products. Alterations take place continually; therefore, this catalogue should not be regarded as an infallible guide to current specifications. All goods are supplied on the condition that the purchaser does all that is reasonably possible to ensure that the user of the equipment is competent in its use. We trust that the descriptions contained in this catalogue will be of assistance and should not be considered a substitute for correct training by qualified personnel.

Product distributors and OEM manufacturers should make all users aware of the following information.

No Connector is to be used in a connection where the gate keeper may be loaded. Care must be taken to avoid loading the connector across the gate, particularly over edges or other obstructions. Please check the anticipated orientation during loading before use.

Connectors and anchorages should be selected to ensure there is appropriate dimensional and configured compatibility. Connectors are not to be connected to another connector. No more than one connector should be connected to any connection point at one time unless this has been specifically designed for and authorized; compatibility and interference must be considered. No foreign items should be used in conjunction with a connector. Connectors are utilized in a variety of fall protection equipment systems. Always verify before use that your equipment consists of products compatible with each other and in conformity with the applicable regulations, standards and directives in force. Where fixed anchorages are used they should be selected to ensure that the connector gate and/or connector locking mechanism cannot be compromised. Gate size as compared to the intended anchorage must be considered before intended use. Connectors with gate openings greater than one inch must not be connected to d-rings or d-ring anchorage connectors. Connectors must be connected such that in the event of a fall, the connector is loaded on its major axis. Loading of connectors in any orientation other than that of the major axis may result in the failure of the connector.

All connectors should be cleaned and lubricated periodically as per PenSafe instructions. If cleaning and lubrication does not result in a perfectly functioning connector, replace the connector immediately. Connector obsolescence is related to use and storage conditions; generally, connectors are conservatively estimated to have a useful life of five years or less.

If you are in any doubt whatsoever about the safe condition of the connector replace it immediately. During use the gate keeper must close and lock. If the connector has been used to arrest a fall it shall be withdrawn from use and destroyed. Also verify that the system has been properly assembled and that each component functions without interfering with any of the other components. Immediately before use, visually and functionally inspect to ensure that the connector is in a serviceable condition and operates correctly. There must not be any signs of wear, corrosion, deformation or defects in general. It is the user's responsibility to ensure that he/she understands the correct and safe use of the connector. Connectors are designed for normal climatic conditions. All contact with chemical reagents or other corrosive substances should be avoided. The user must be adequately trained in the appropriate techniques and security measures to be adopted. PenSafe assumes responsibility only for the uses for which the product is designed, and is not responsible for product failure related to poor maintenance, user negligence, or where the product has been modified or repaired by persons not specifically authorized. PenSafe declines any and all responsibility for accidents, injuries or death due to improper application and incorrect use of its products by the user and/or failure to follow the above mentioned instructions.

WARNINGS

WARNINGS - CONNECTING COMPONENTS



The following depictions illustrate improper usage of connectors in various applications. Care must be taken to ensure that connectors are not used in configurations where the locking mechanism can be compromised or the hook body is subject to deflection or inappropriate stress. **Note that these warnings apply to all connectors whether they are certified to, or meet or exceed, the requirements of CSA Z259.12-01, ANSI Z359.12 -2019, EN 362:2004 or NFPA 2500 (1983), 2022 ED.**

Connector elements or components which may fail as a result of inappropriate configurations are depicted in red.



Dimensional & Configured Incompatibility

- Connector and anchorage should be selected such that the gate keeper mechanism is not subject to load.
- Gate size should be appropriate to the size of the anchorage.

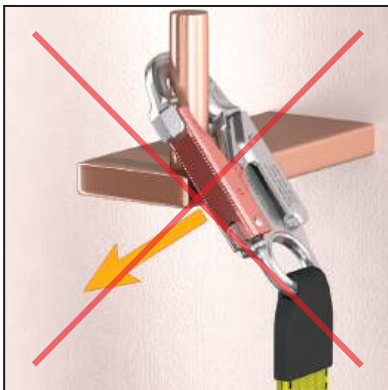

Gate Side Loading

- Ensure working area is free of obstructions which could compromise the gate keeper mechanism.

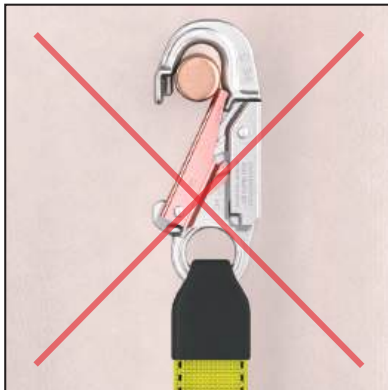

Improper Connection

- Ensure that hook is compatible with anchorage.
- Gate keeper must close and lock.

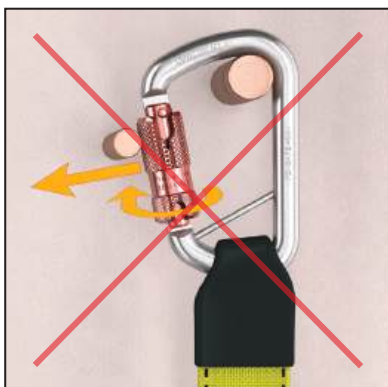

Accidental Barrel Disengagement

- Ensure working area is free of obstructions which could compromise gate mechanism or result in accidental disengagement.

WARNINGS

WARNINGS - CONNECTING COMPONENTS



The following depictions illustrate improper usage of connectors in various applications. Care must be taken to ensure that connectors are not used in configurations where the locking mechanism can be compromised or the hook body is subject to deflection or inappropriate stress. **Note that these warnings apply to all connectors whether they are certified to, or meet or exceed, the requirements of CSA Z259.12-01, ANSI Z359.12 -2019, EN 362:2004 or NFPA 2500 (1983), 2022 ED.**

Connector elements or components which may fail as a result of inappropriate configurations are depicted in red.



Gate Face Loading

- Ensure working area is free of obstructions which could place a force/load on the face of the gate keeper mechanism.

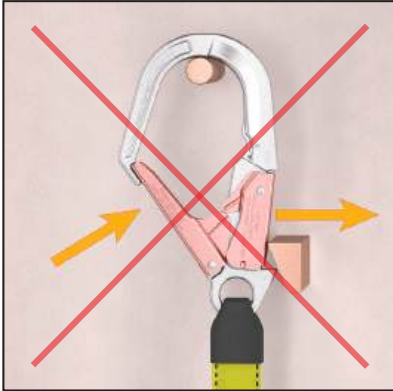

Accidental Lock-Lever Deactivation

- Ensure working area is free of obstructions which could accidentally engage the lock lever mechanism and result in accidental disengagement.

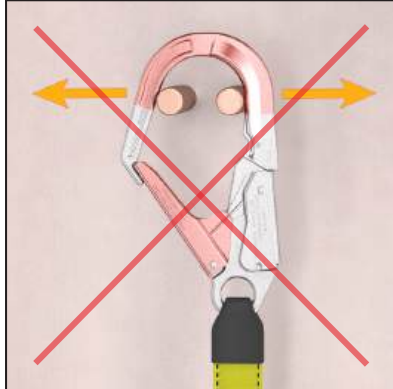

Connector Tip Loading

- Configure application such that gate mechanism and hook tip are not loaded.

WARNINGS

WARNINGS - CONNECTING COMPONENTS



The following depictions illustrate improper usage of connectors in various applications. Care must be taken to ensure that connectors are not used in configurations where the locking mechanism can be compromised or the hook body is subject to deflection or inappropriate stress. **Note that these warnings apply to all connectors whether they are certified to, or meet or exceed, the requirements of CSA Z259.12-01, ANSI Z359.12 -2019, EN 362:2004 or NFPA 2500 (1983), 2022 ED.**

Connector elements or components which may fail as a result of inappropriate configurations are depicted in red.

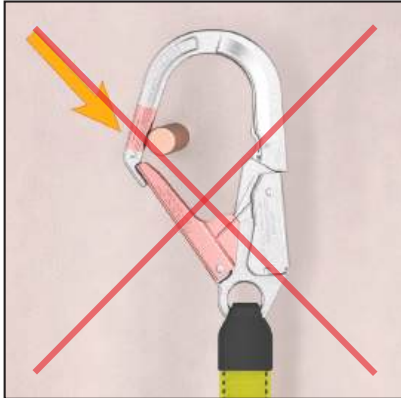

Multiple Loading

- Do not subject the hook to multiple forces which could cause hook body deflection resulting in gate failure.



Deliberate Lock-Lever Deactivation

- The connector locking keeper mechanism should not be disabled.

PART NUMBER REFERENCE

PART #	PAGE
1010	49
1022	50
1024	49
1028	49
1034	53
1038	53
1062	47
1220	48
1222	44
1223	45
1224	45
1226	45
1227	54
2022	50
3063	36
3064	36
3068	32
3200	35
3220	35
3221	33
3230	36
3250	32
3251	32
3253	32
3400	33
3652	34
3662	34
3731	27
3732	27
3742	27
3830	35
3840	34
3841	34
3850	35
4550	56
4650	8
4692ANSI	8
4693ANSI	8
5045	56

PART #	PAGE
5064	54
5066	54
5692ANSI	7
5870ANSI	10
5990ANSI	11
5944ANSI	10
6600	7
6650	7
6692ANSI	6
7360	29
7500	39
7550	53
7600	39
7700	39
7800	39
9029	33
9031	49
9052	43
9053	42
9055	43
9058	44
9072	43
9074	42
9076	42
9078	44
9111	42
9154	43
9156	44
9224	45
9225	46
9225-2	46
9232/0516	46
9233/0516	46
9242	47
9245	48
9254	48
9256	48
9260	47
9290	47

PART #	PAGE
9400	33
9500	37
9652	7
9692ANSI	6
9695ANSI	6
9697ANSI	6
9780	27
9840	36
A1187	24
A213	56
A333PS	19
A337PS	20
A353PS	20
A357PS	20
A393PS-26kN	20
A393PS-30kN	21
A397PS-26kN	21
A397PS-30kN	21
A750	40
A760	40
A843PS	21
A847PS	22
A853PS	22
A857PS	22
A903PS	22
A907PS	23
A913PS	23
A917PS	24
A953PS	23
A957PS	23
A973PS	24
A977PS	24
C332	19
C335	19
C335-35	19
C415	16
C455	16
C714PS	18
C734L	25

PART #	PAGE
C734PS	18
C763L	25
C763PS	18
C772	17
C775	17
C777	17
C812PS	16
C813L	25
C813PS	16
C843PS	17
C847PS	18
MBA03	57
MBK02	57
MBK03	58
MBP01	58
MBP02	58
MT01	57
MT02	57
PS22044	54
RGL6030	30
T1532	56



PENSAFE™

STRENGTH & SECURITY

PENSAFE INC. t:905-643-7188
1175 Barton St. f:905-643-5088
Unit # 4 tf: 1-866-212-2211
Stoney Creek, Ontario Sales@pensafe.ca
Canada L8E 5H1
<http://www.pensafe.ca>